

ATELIÉR ARCHITEKTONICKÉ KOMPOZICE

Nhat Anh Le

SRGSLV

Architektura a stavitelství, FSv ČVUT
AAKO ZS 2020 / 2021
ATELIER DVOŘÁK | HOUSOVA MIZEROVÁ



ARCHITEKTI

ARCHITEKT



MOTIV ARCHITEKTA - DETAIL, SKICA

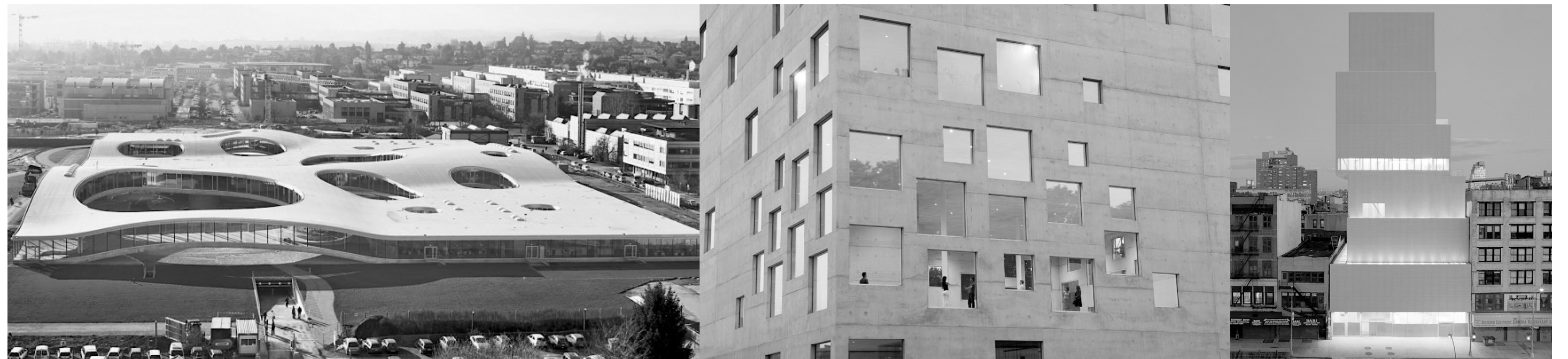

ARCHITEKT 2



MOTIV ARCHITEKTA - DETAIL, SKICA



ELEMENTY

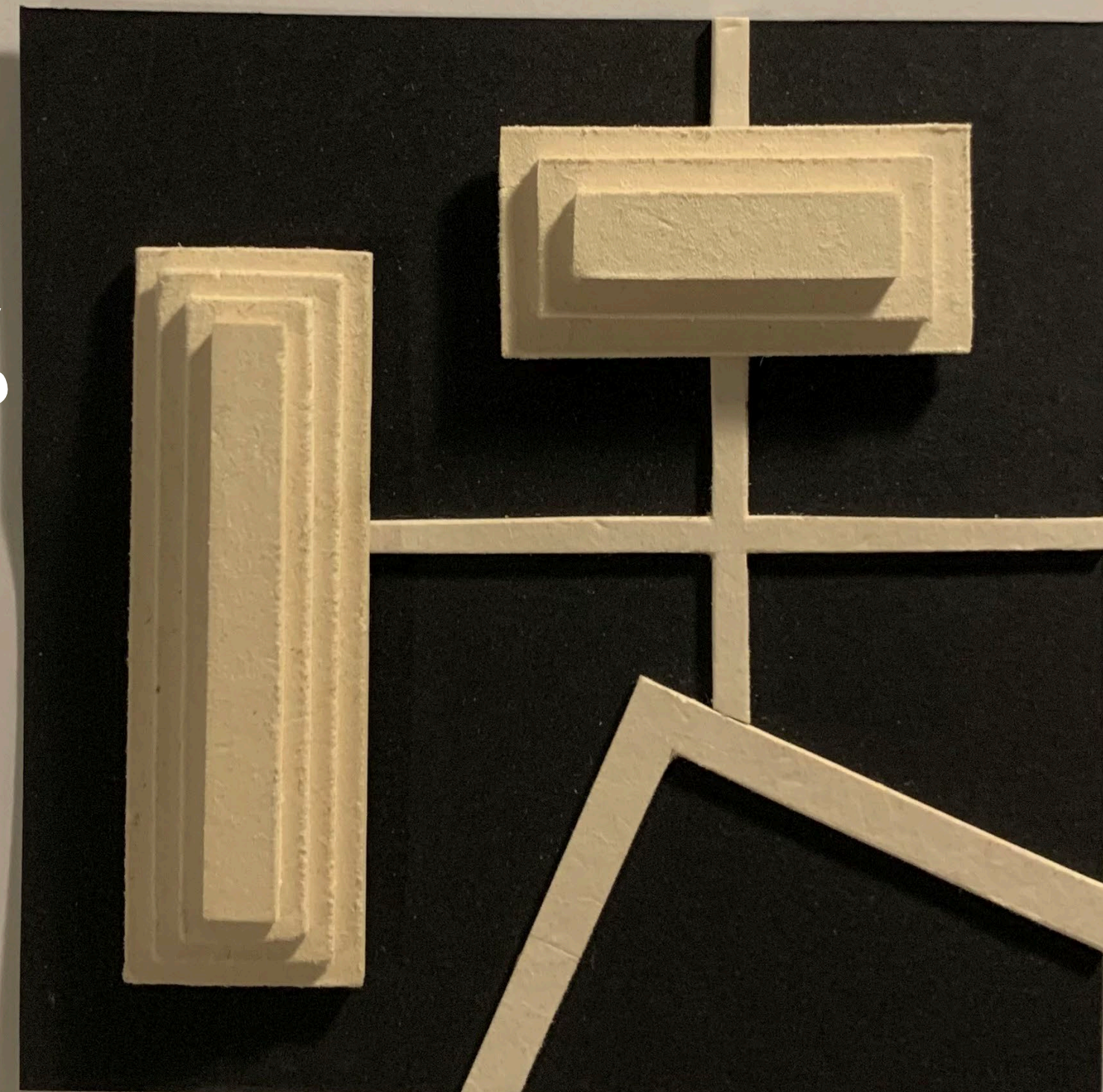
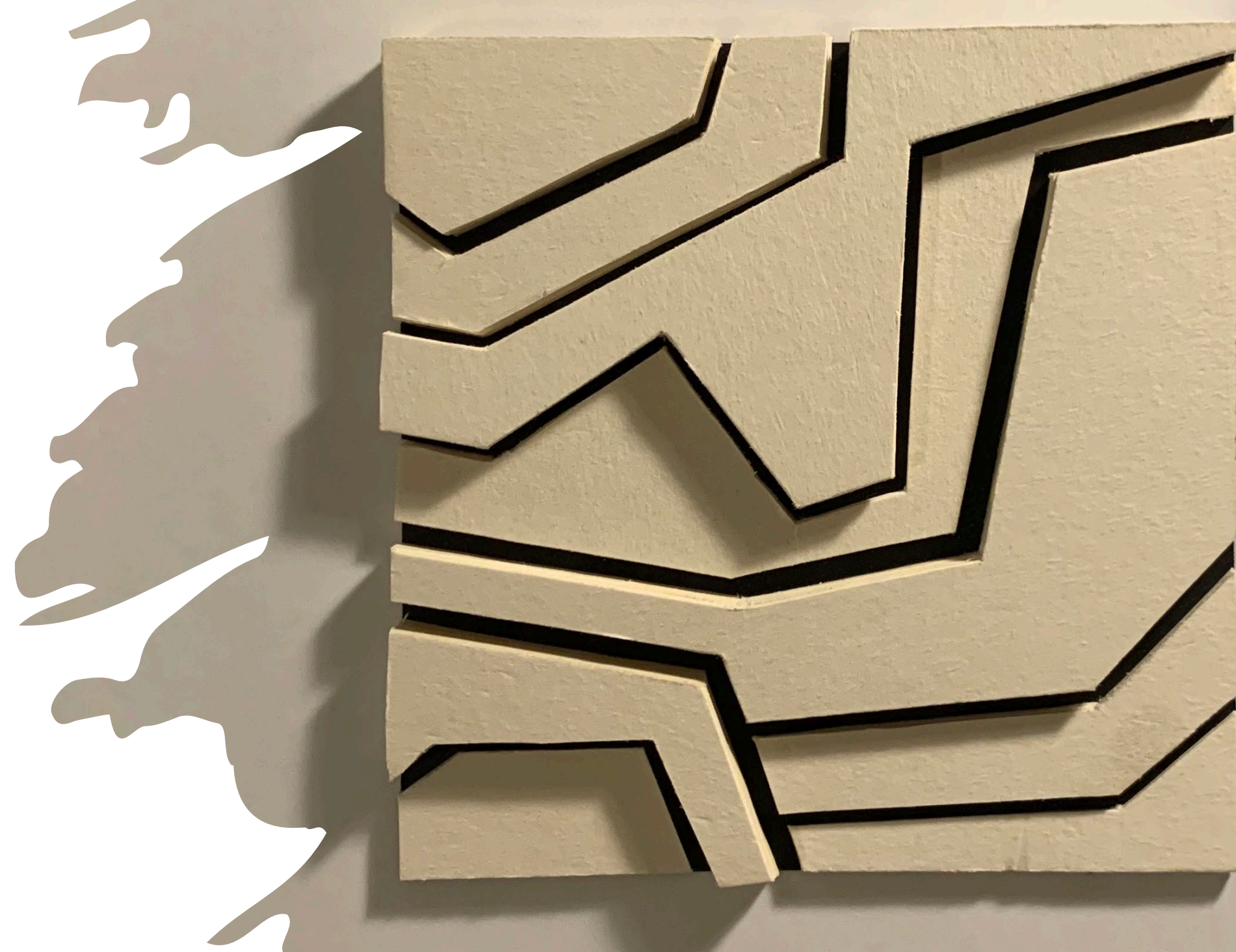

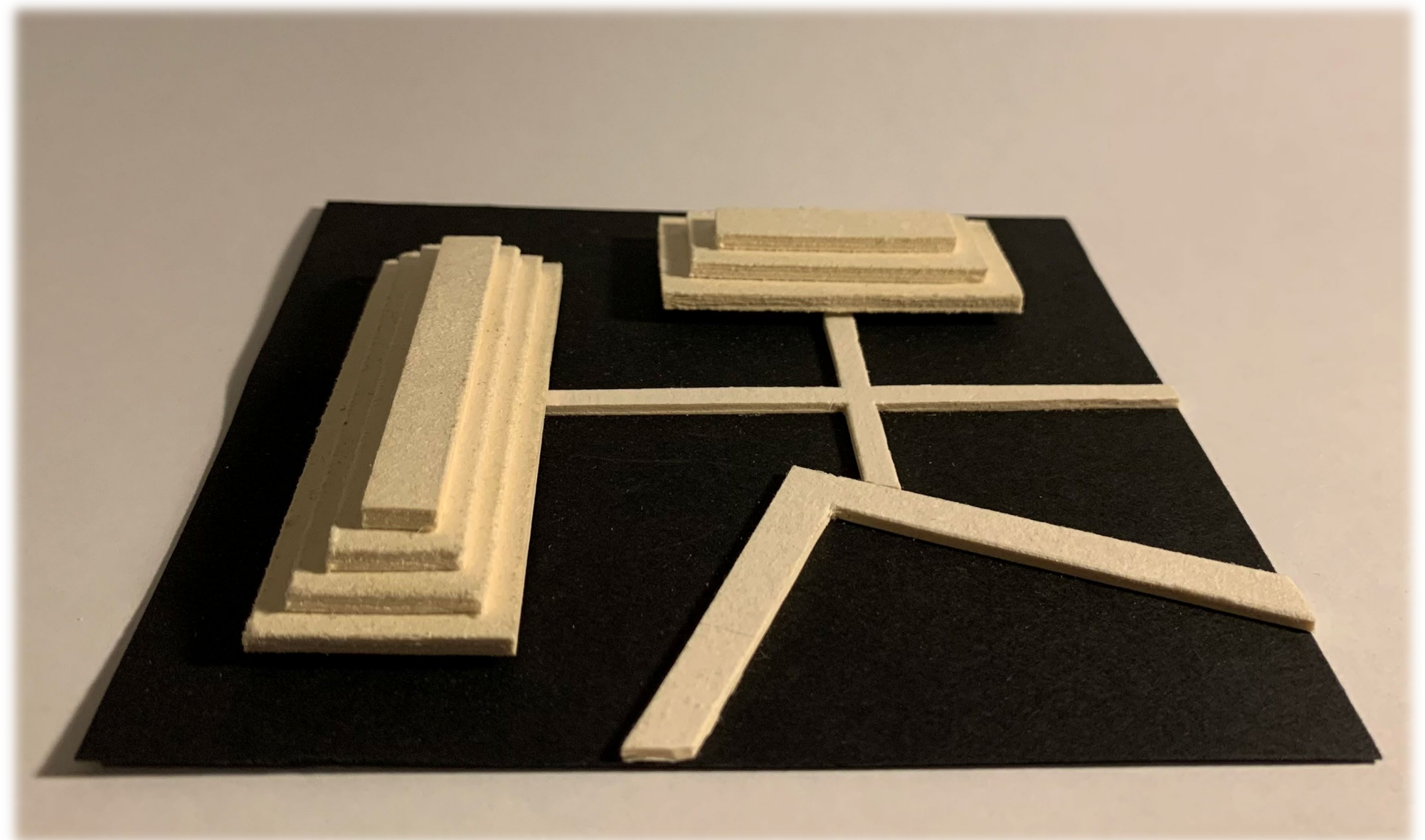
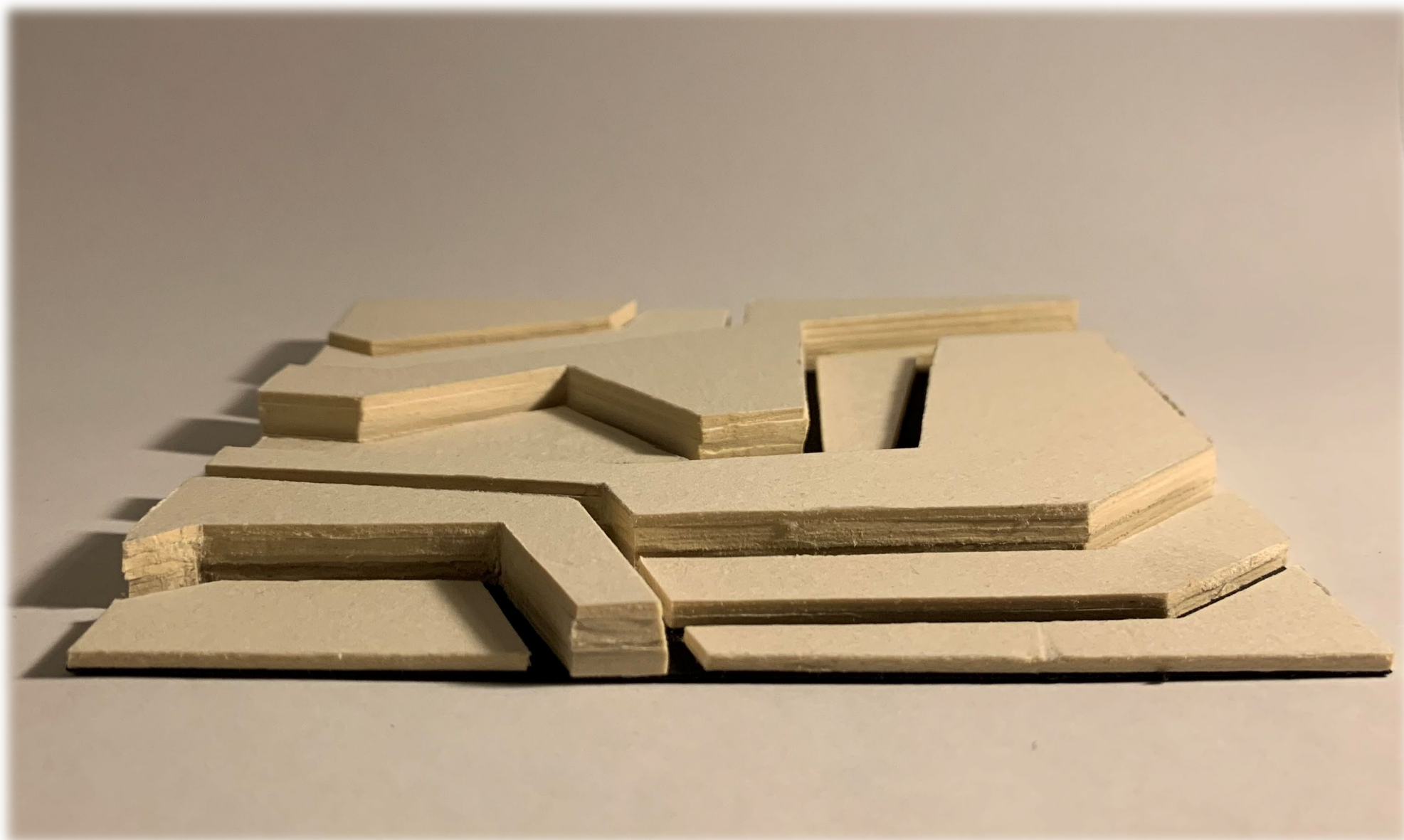
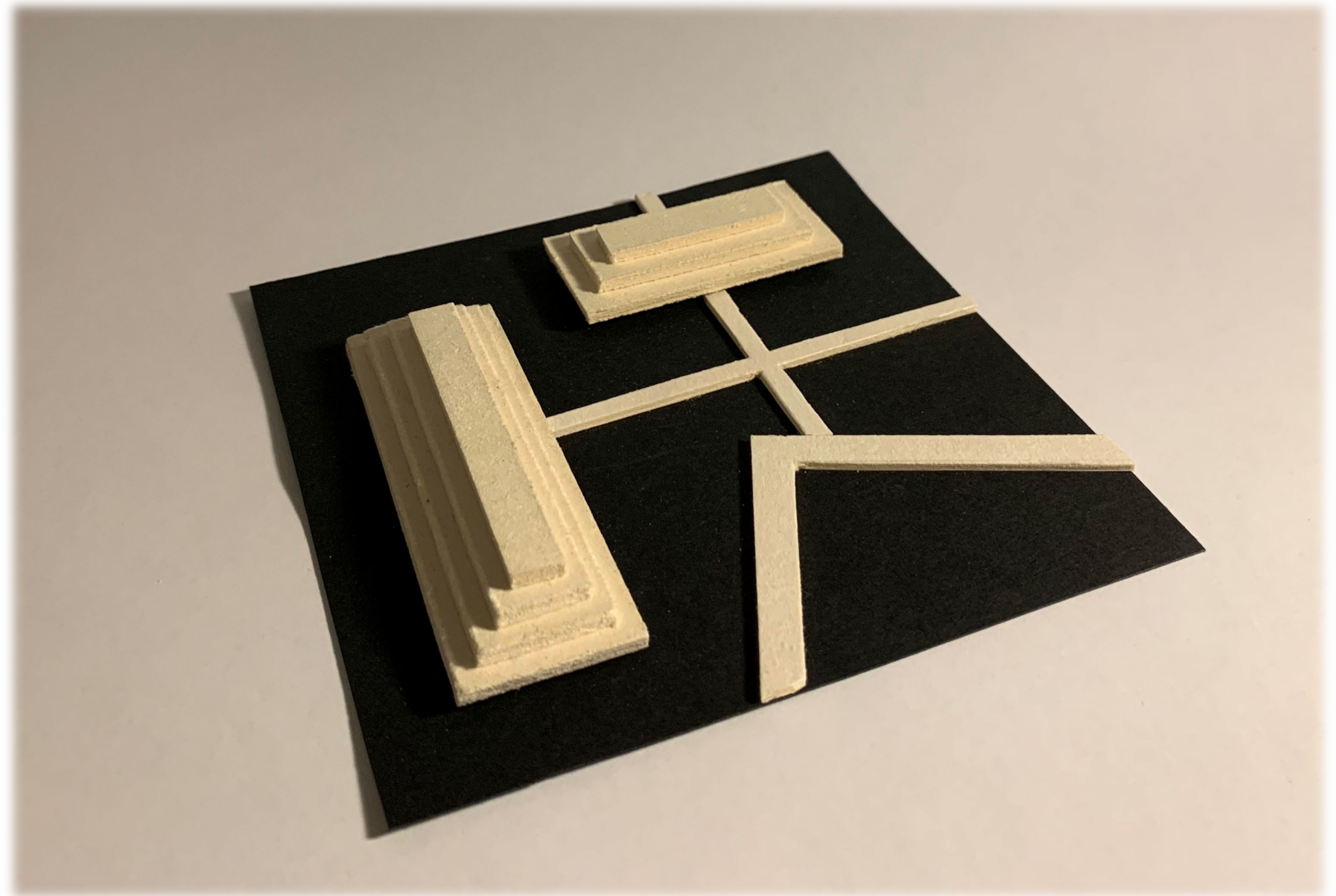
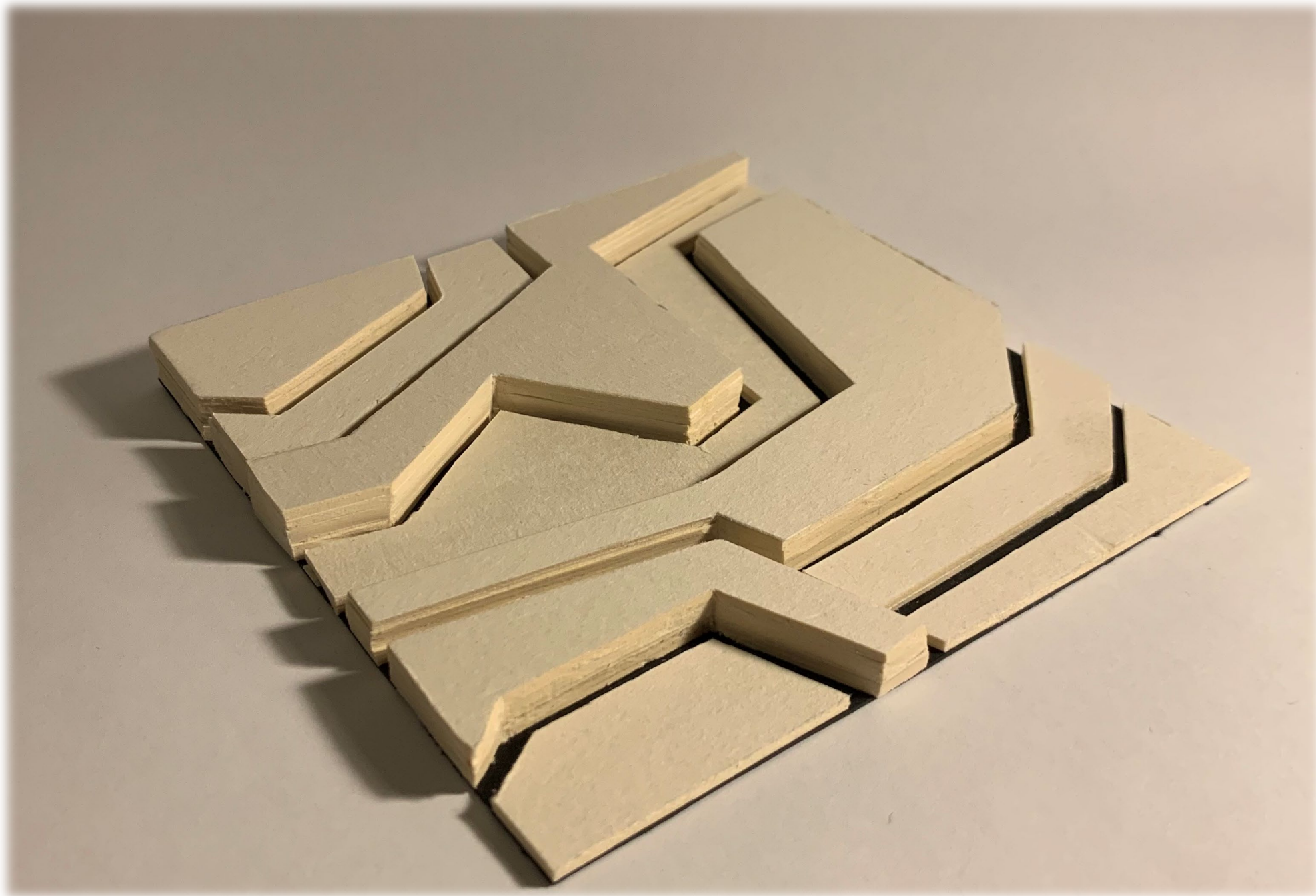

An abstract sculpture constructed from multiple layers of light-colored cardboard. The structure is composed of several sharp, triangular and quadrilateral planes that intersect at various angles, creating a complex, three-dimensional geometric form. The planes are layered, giving the sculpture a sense of depth and volume. The background is a neutral, light gray, and the lighting is soft, highlighting the edges and surfaces of the cardboard. A large, semi-transparent white circle is positioned on the right side of the image, partially overlapping the sculpture and the text.

PROSTOROVÁ KOMPOZICE

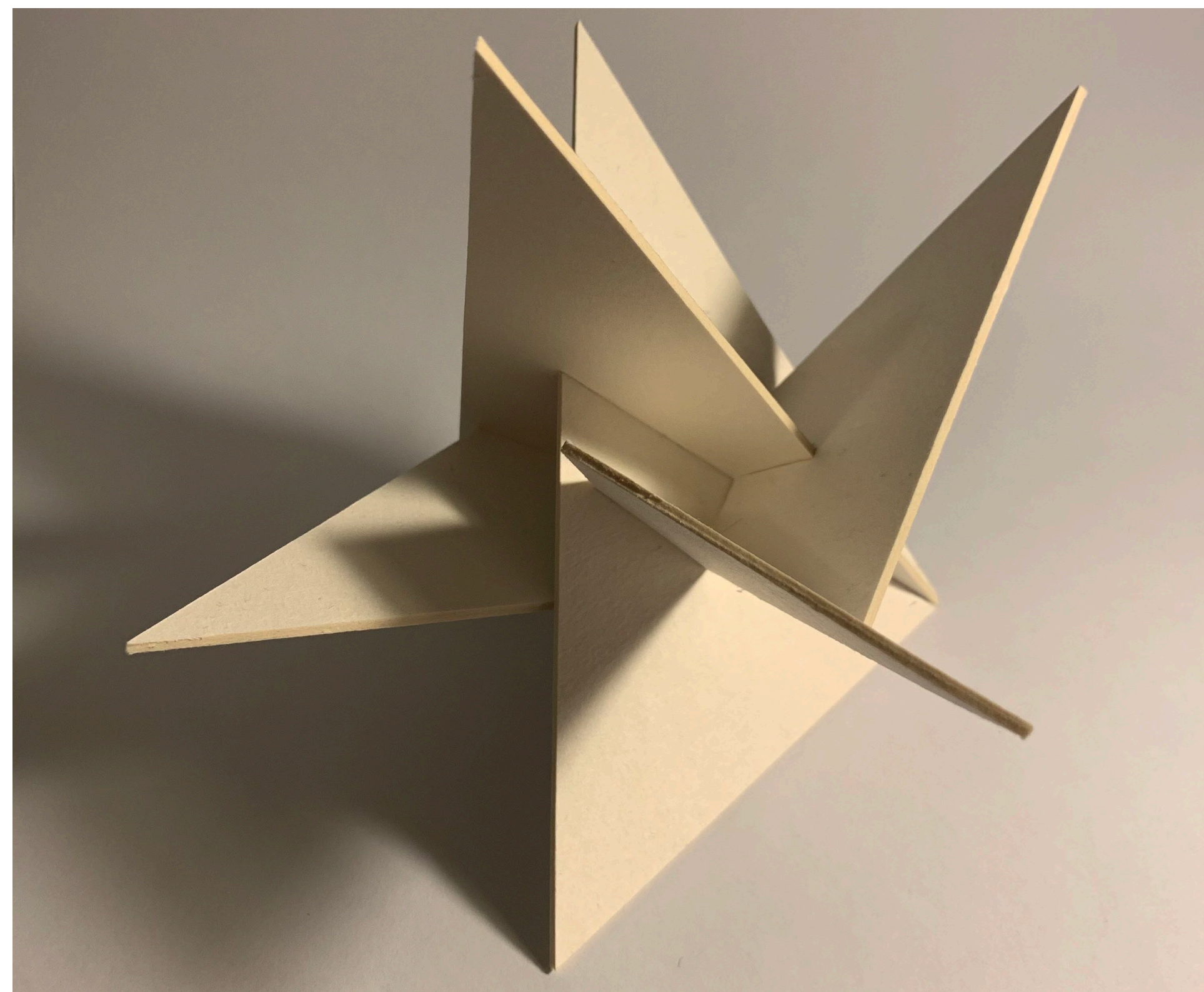
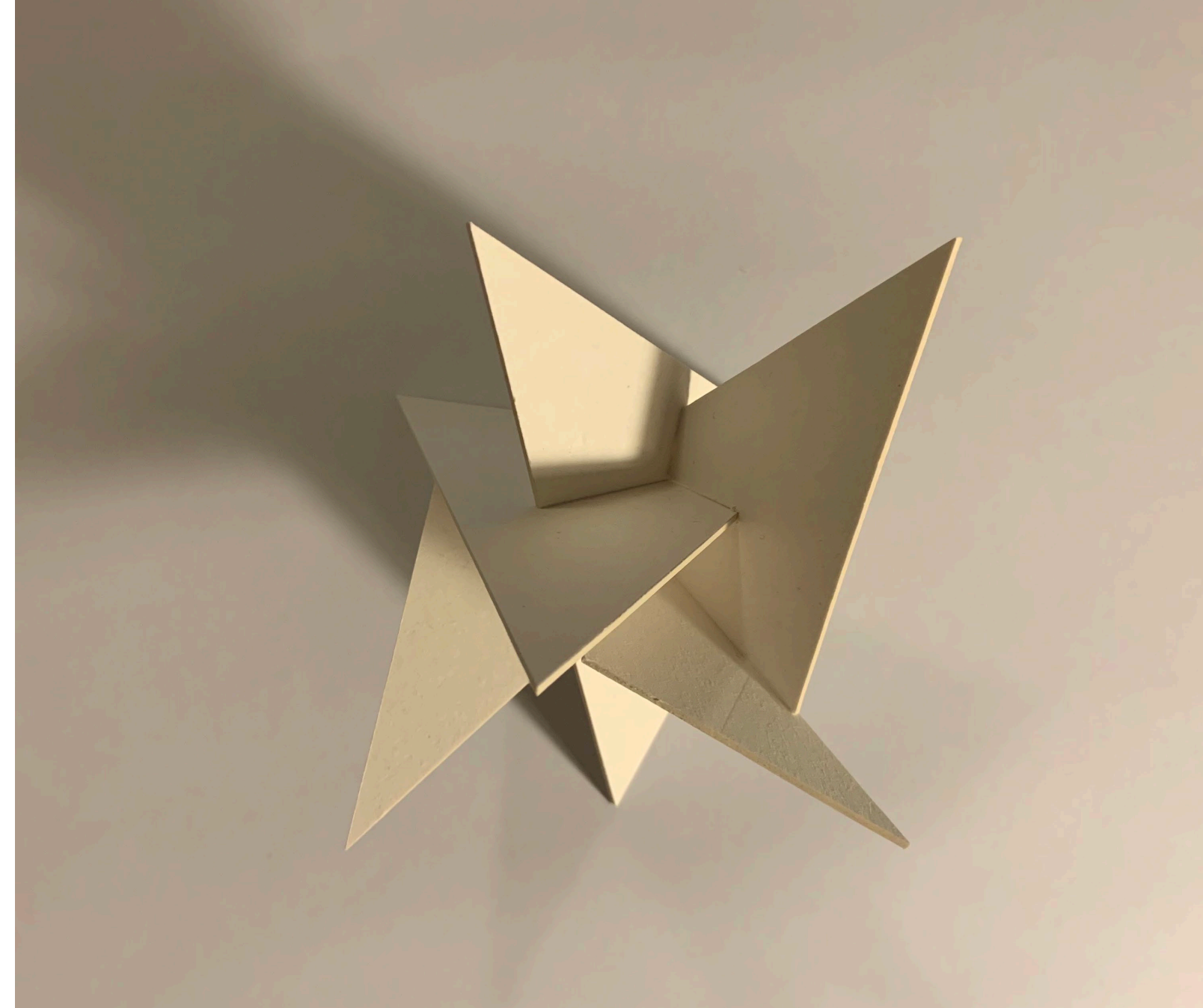
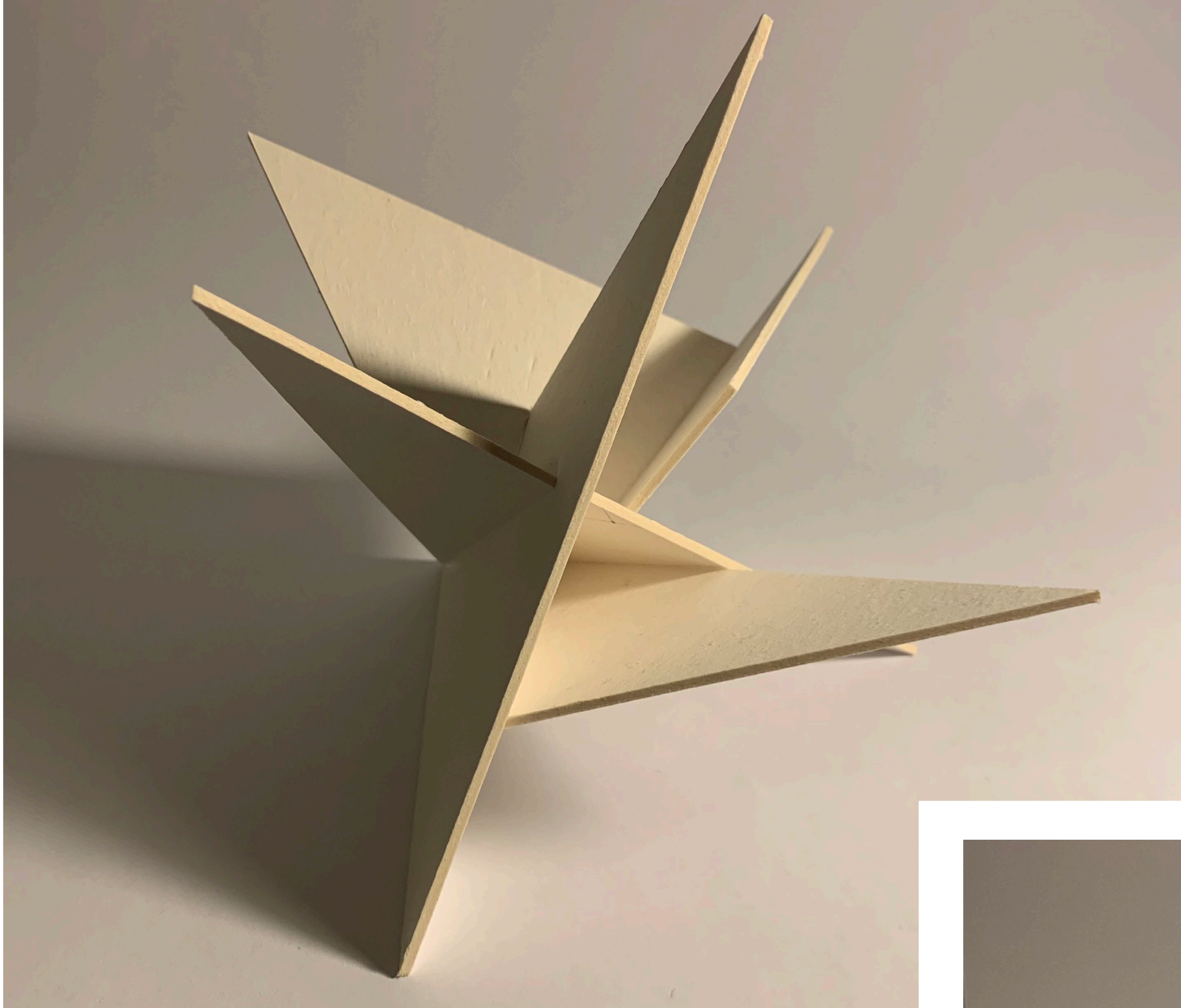

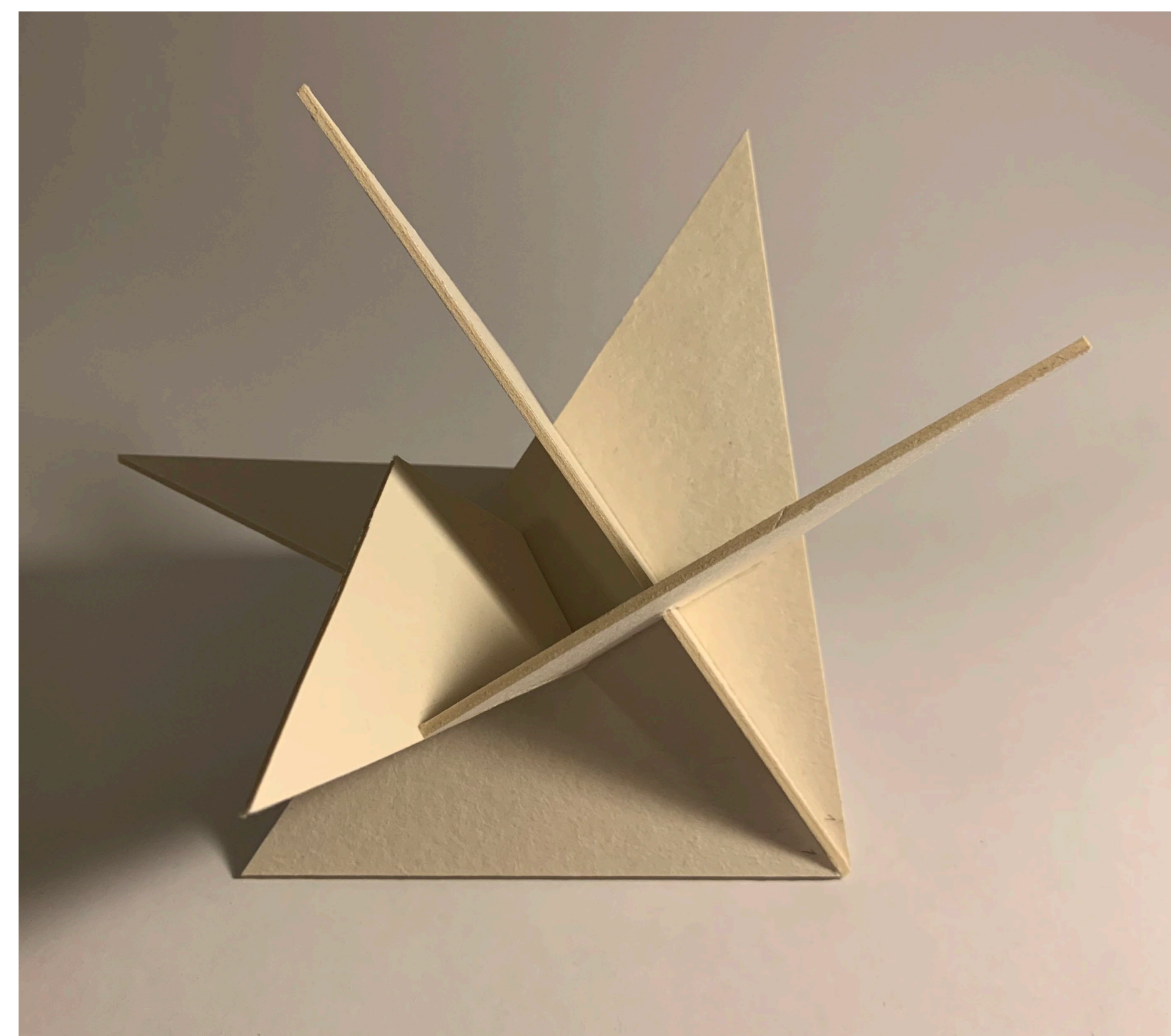
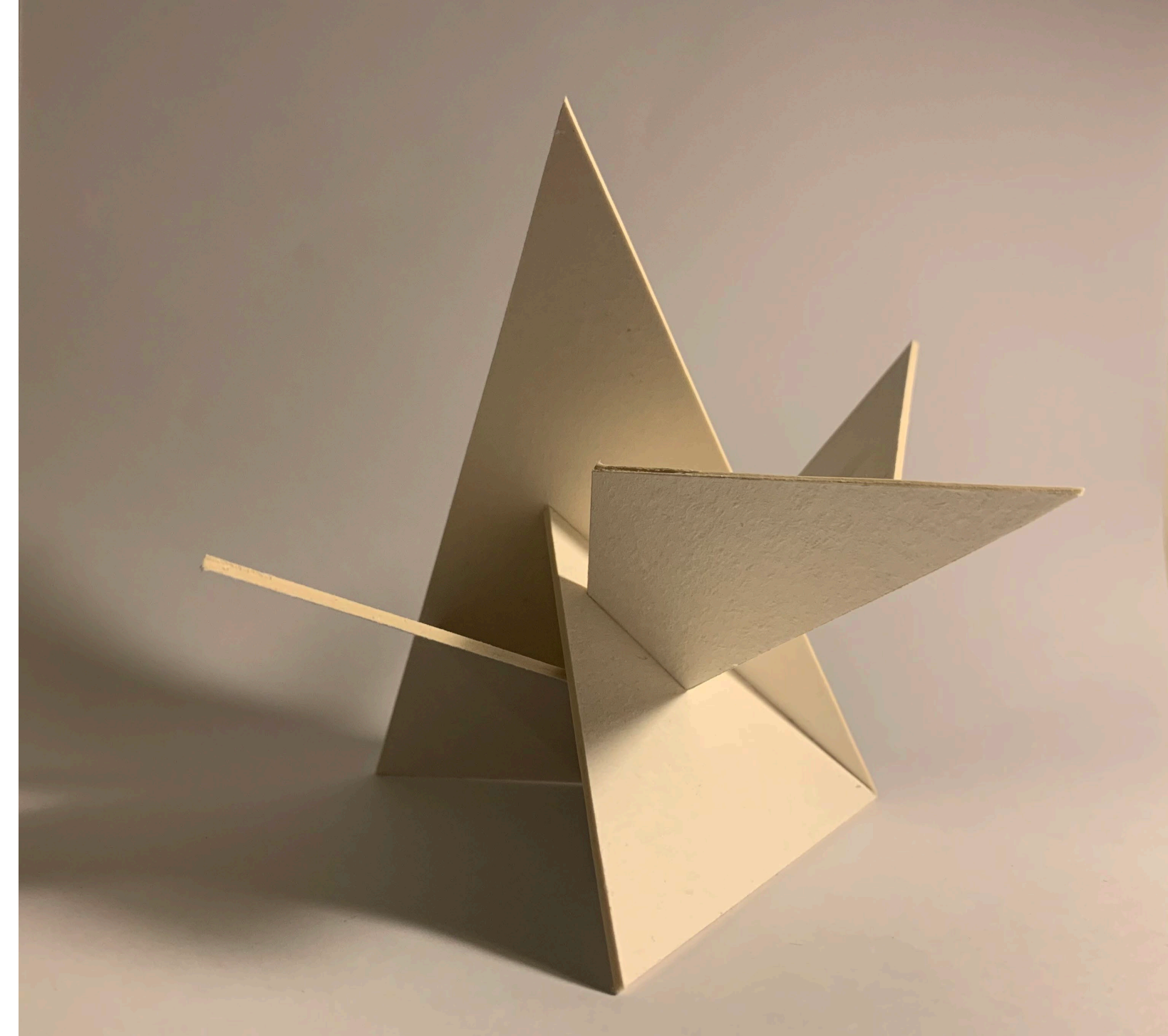
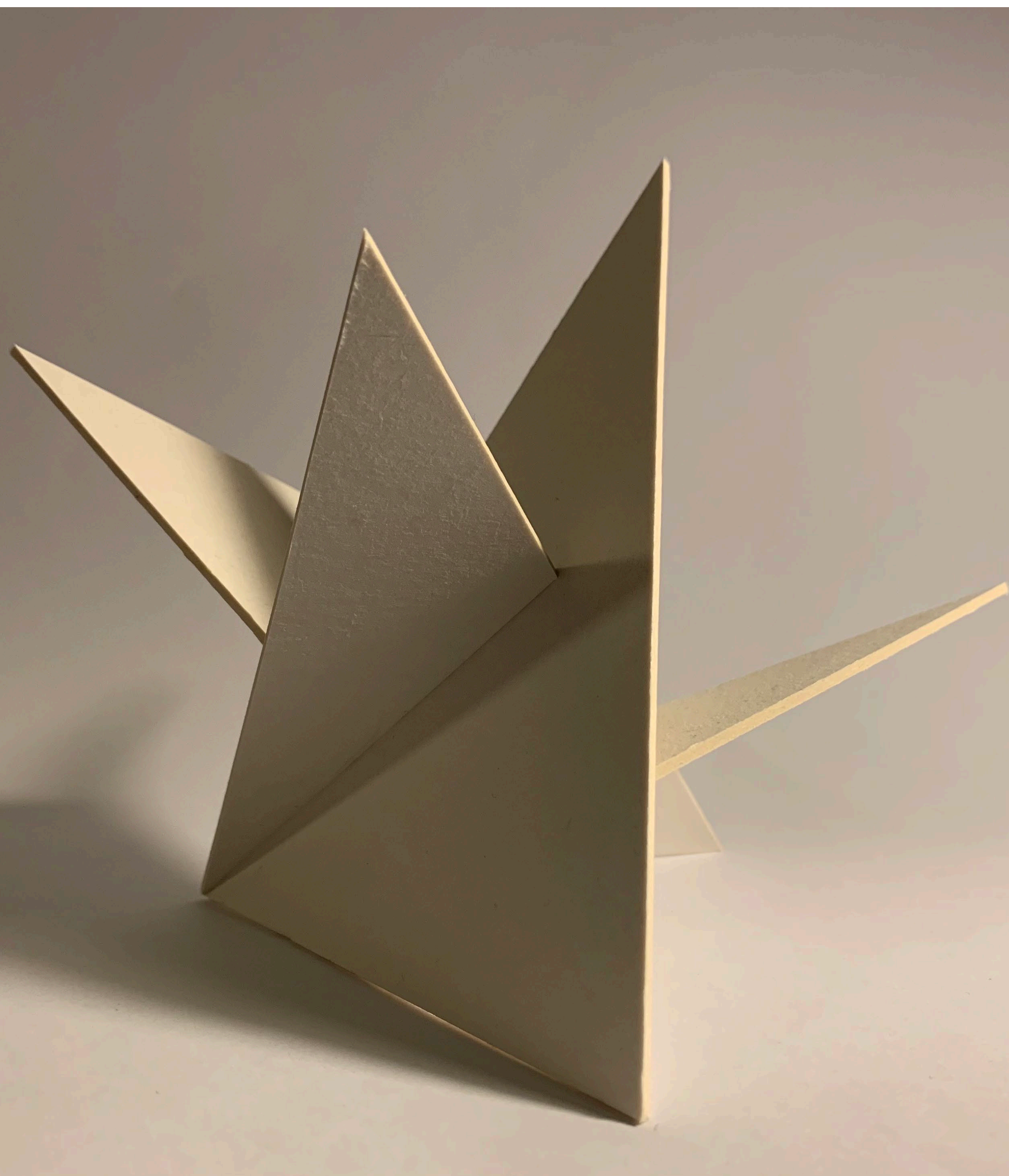

FASÁDA

INSPIRACE

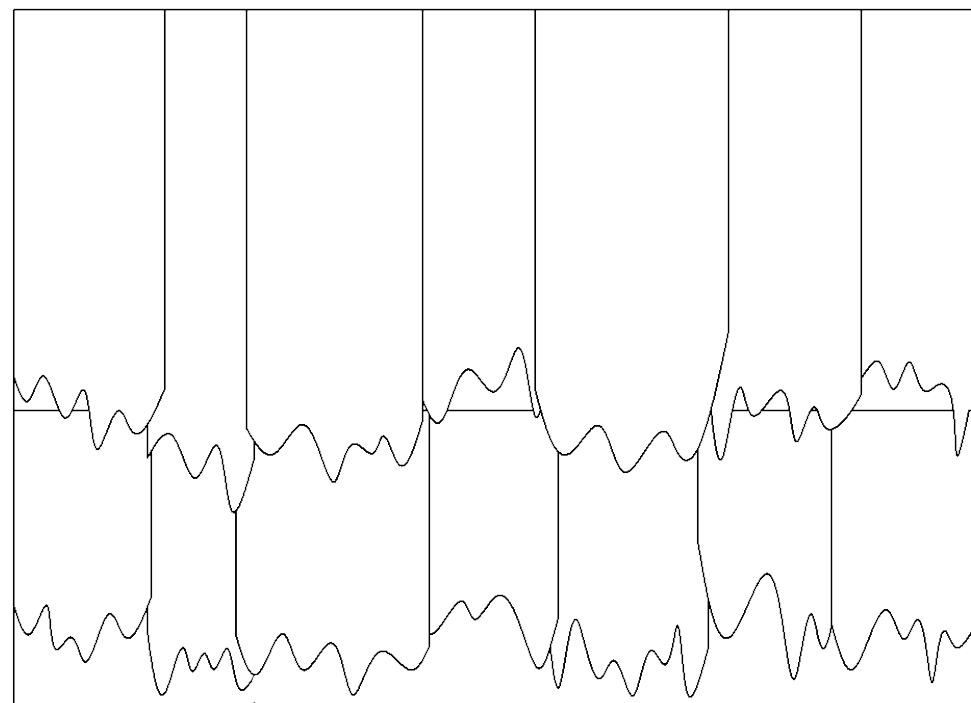
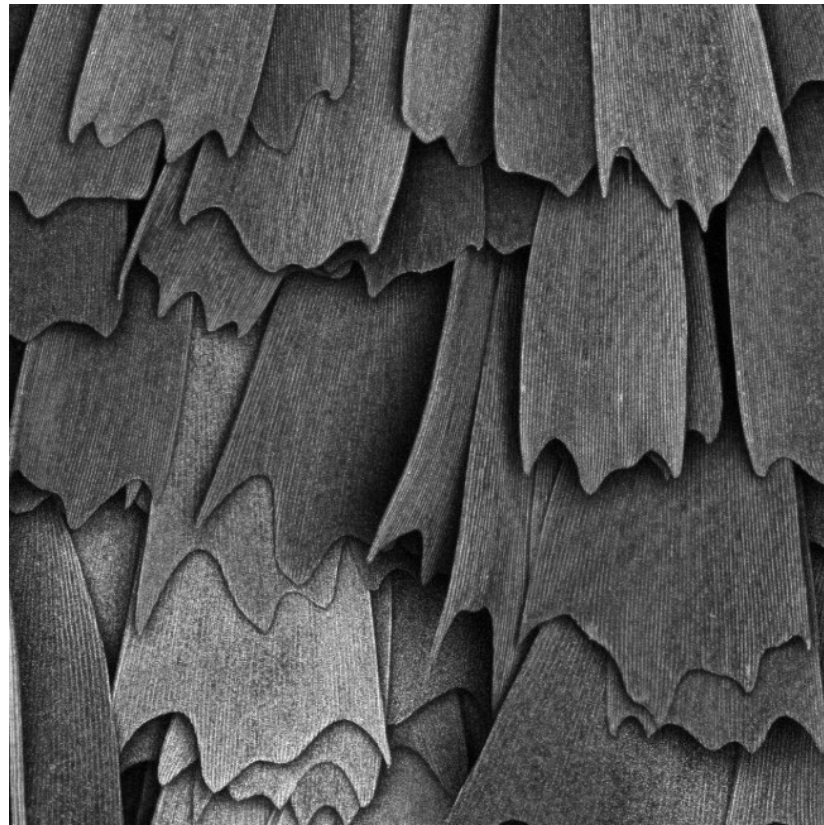

KOMPOZICE FASÁDY

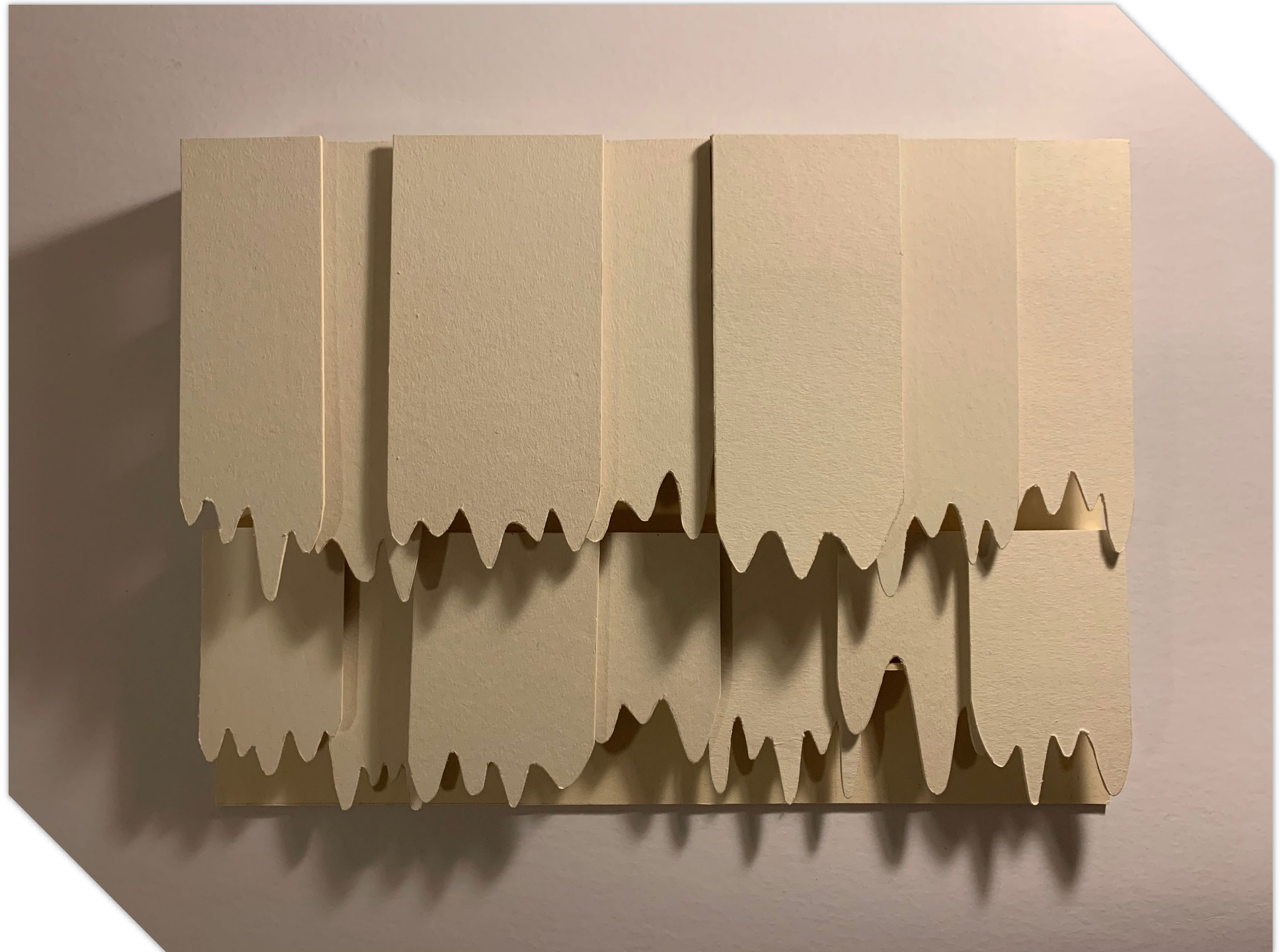

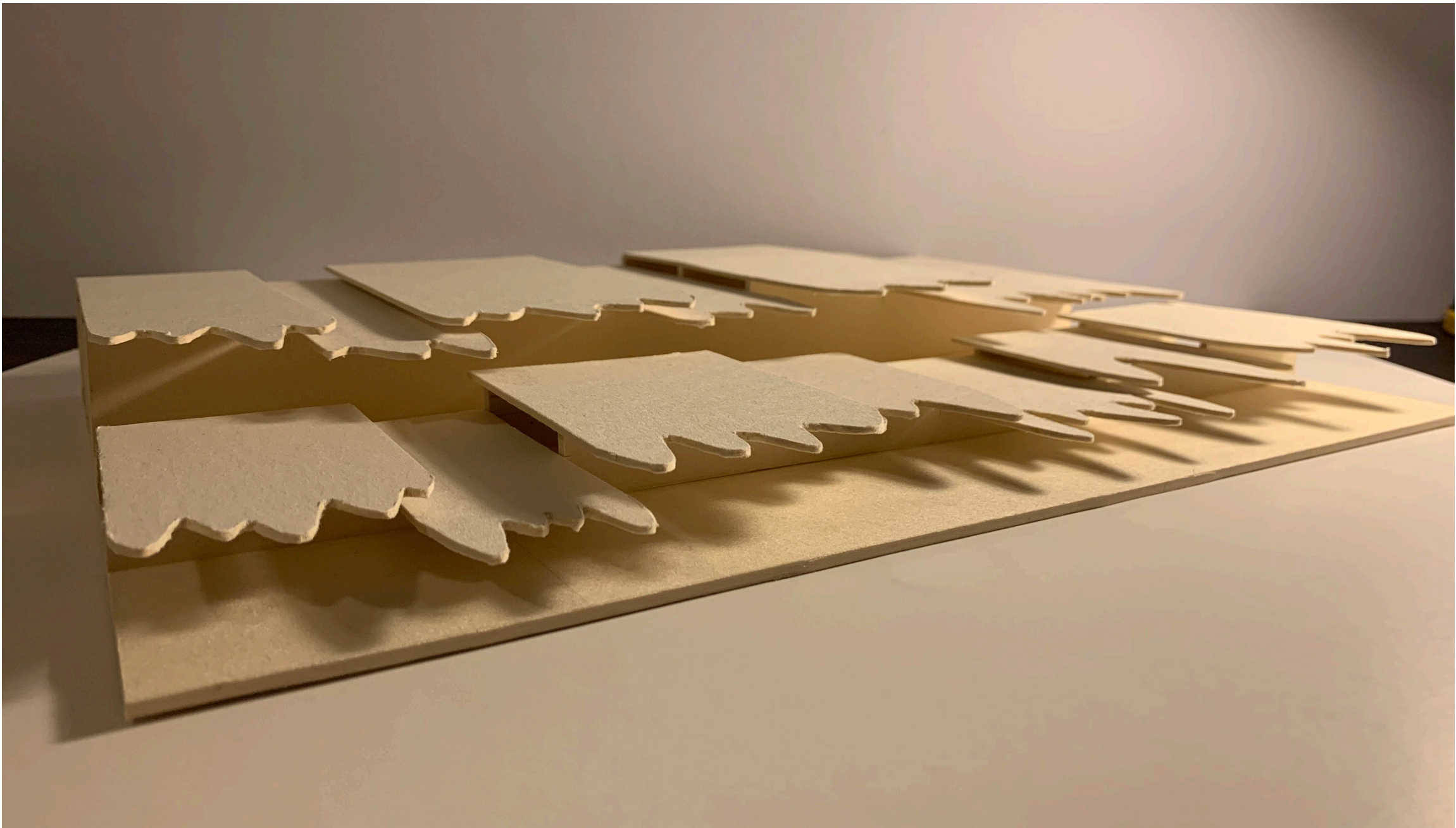
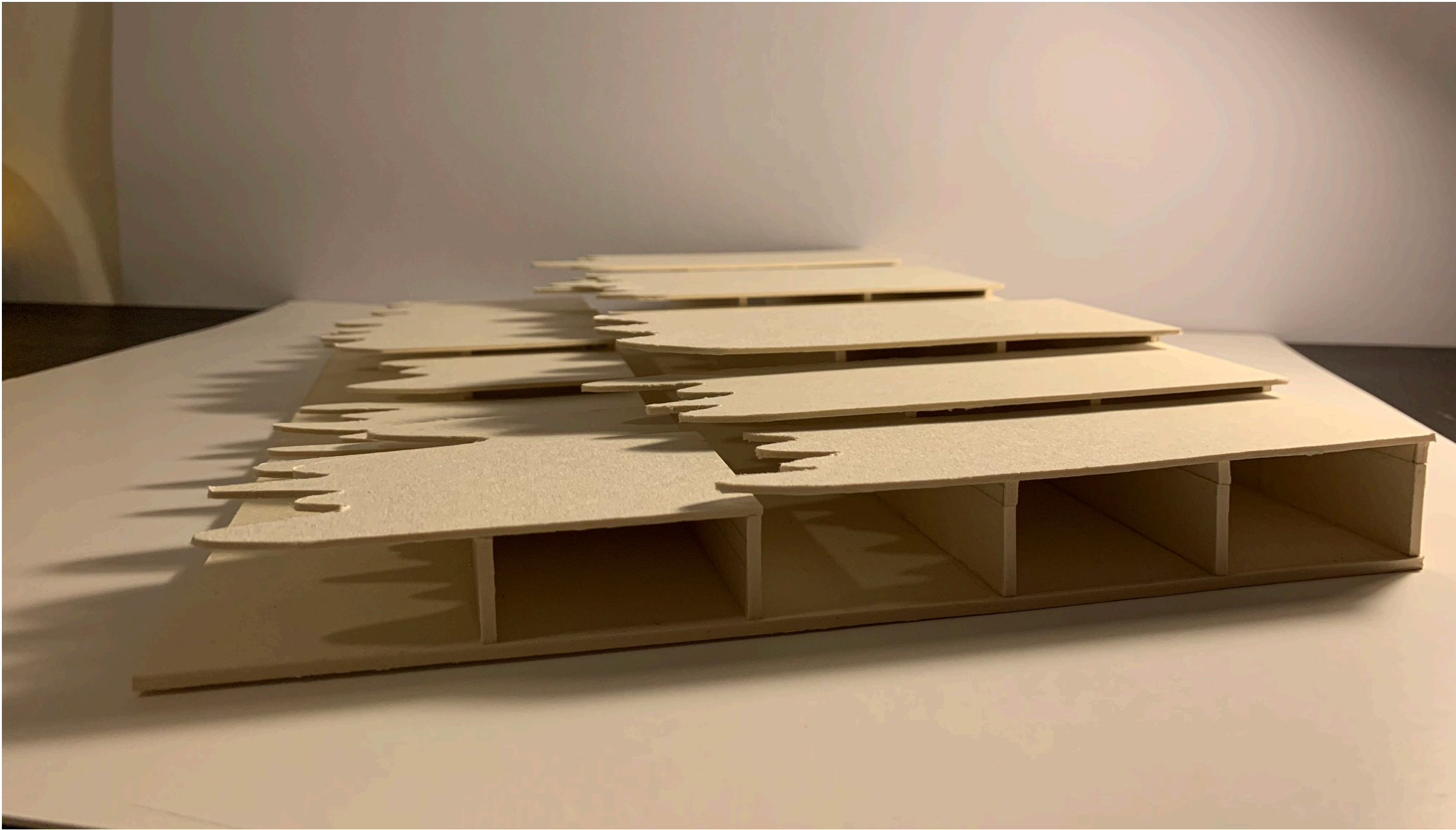
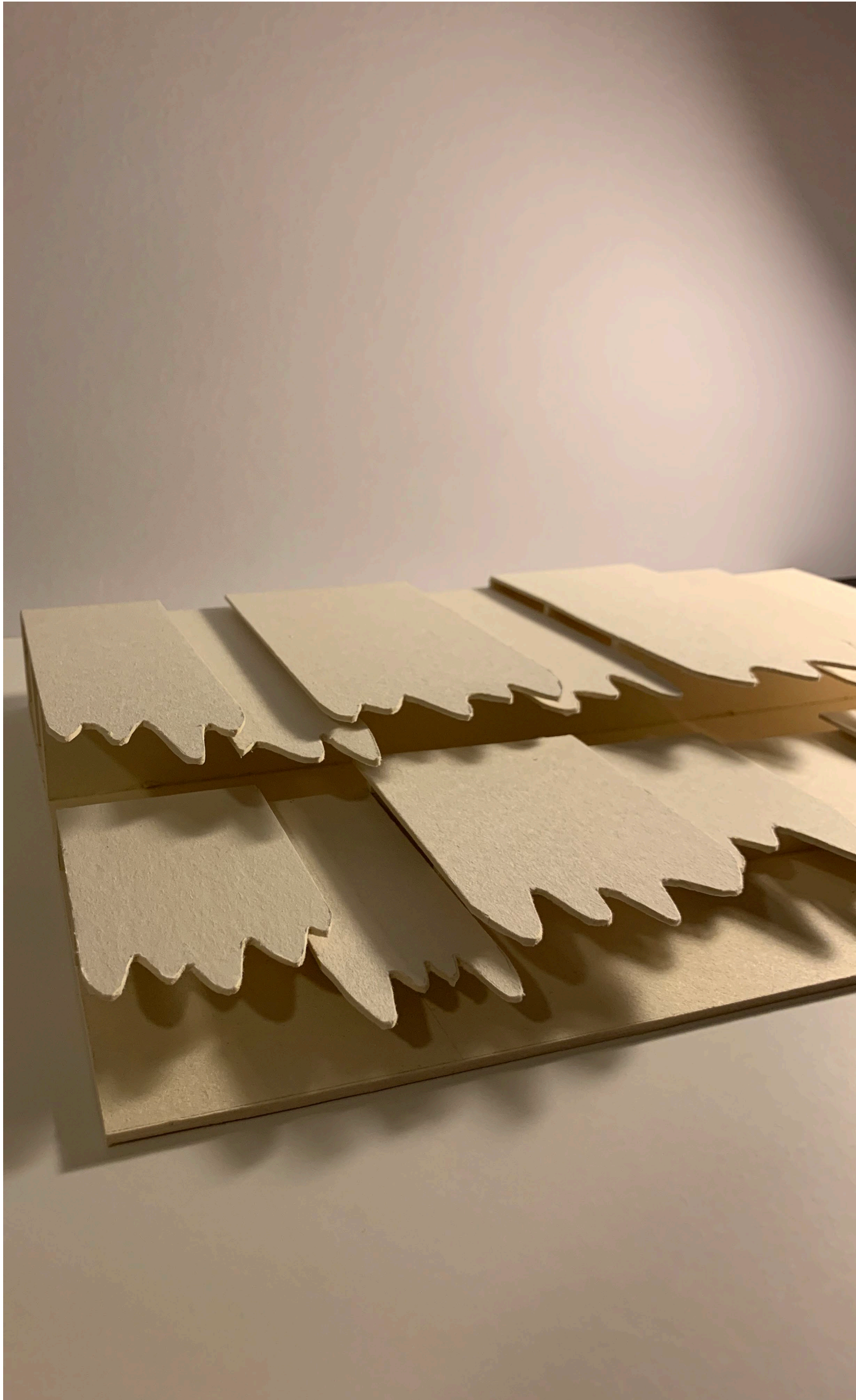

PŮDORYS

INSPIRACE

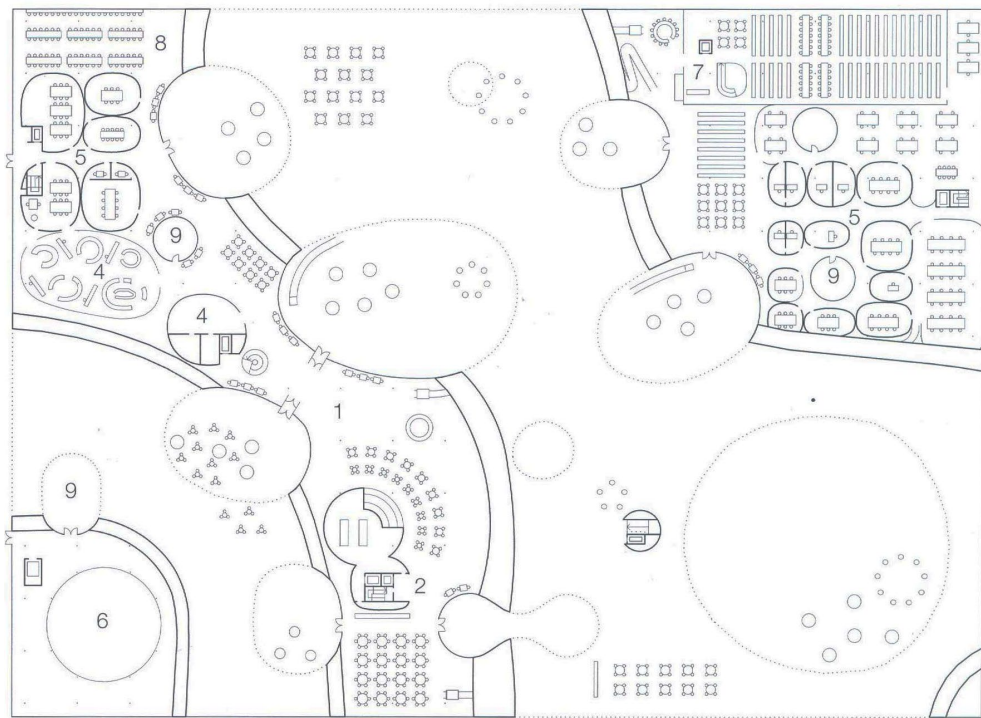

KOMPOZICE PŮDORYSU



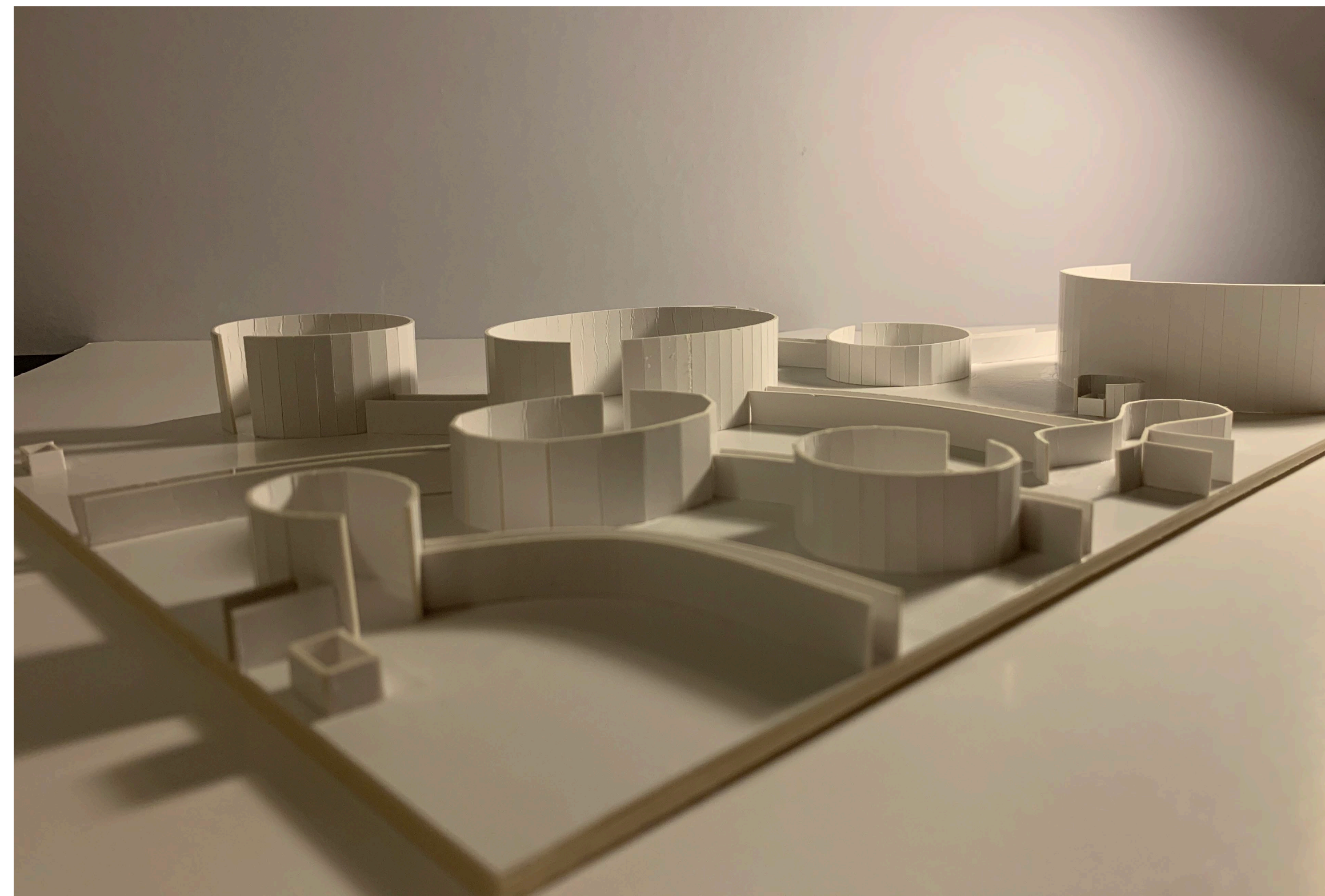
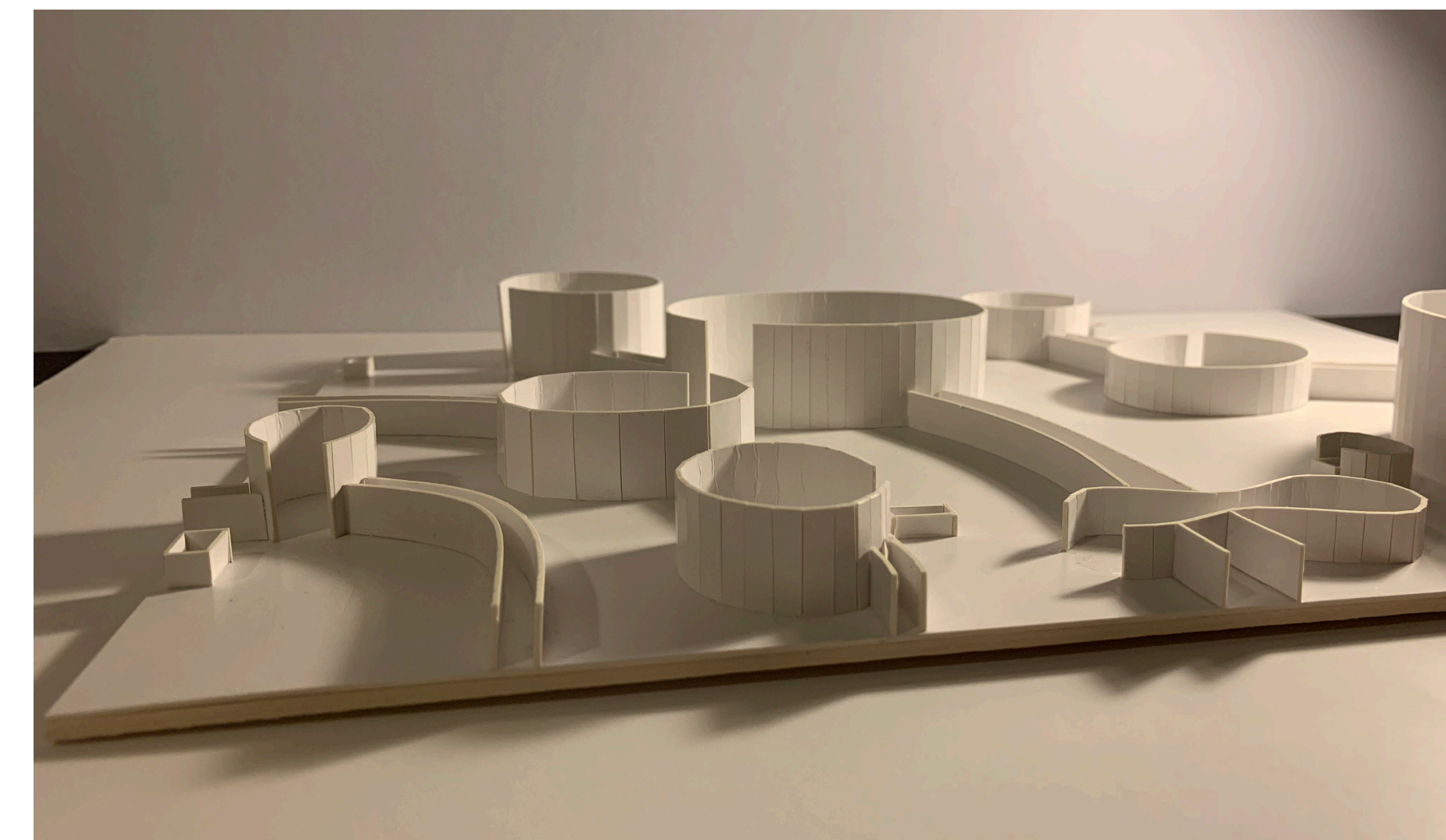
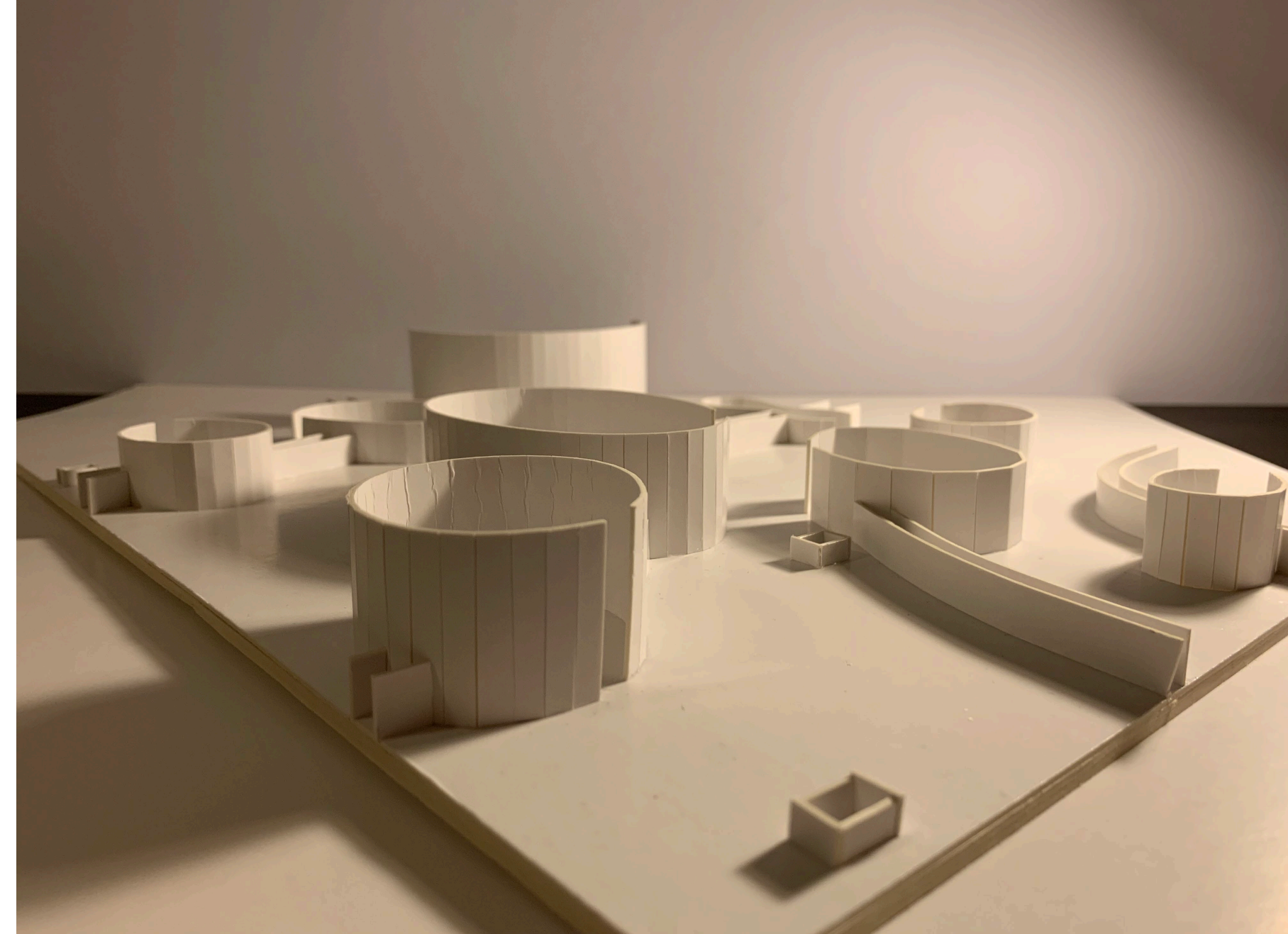
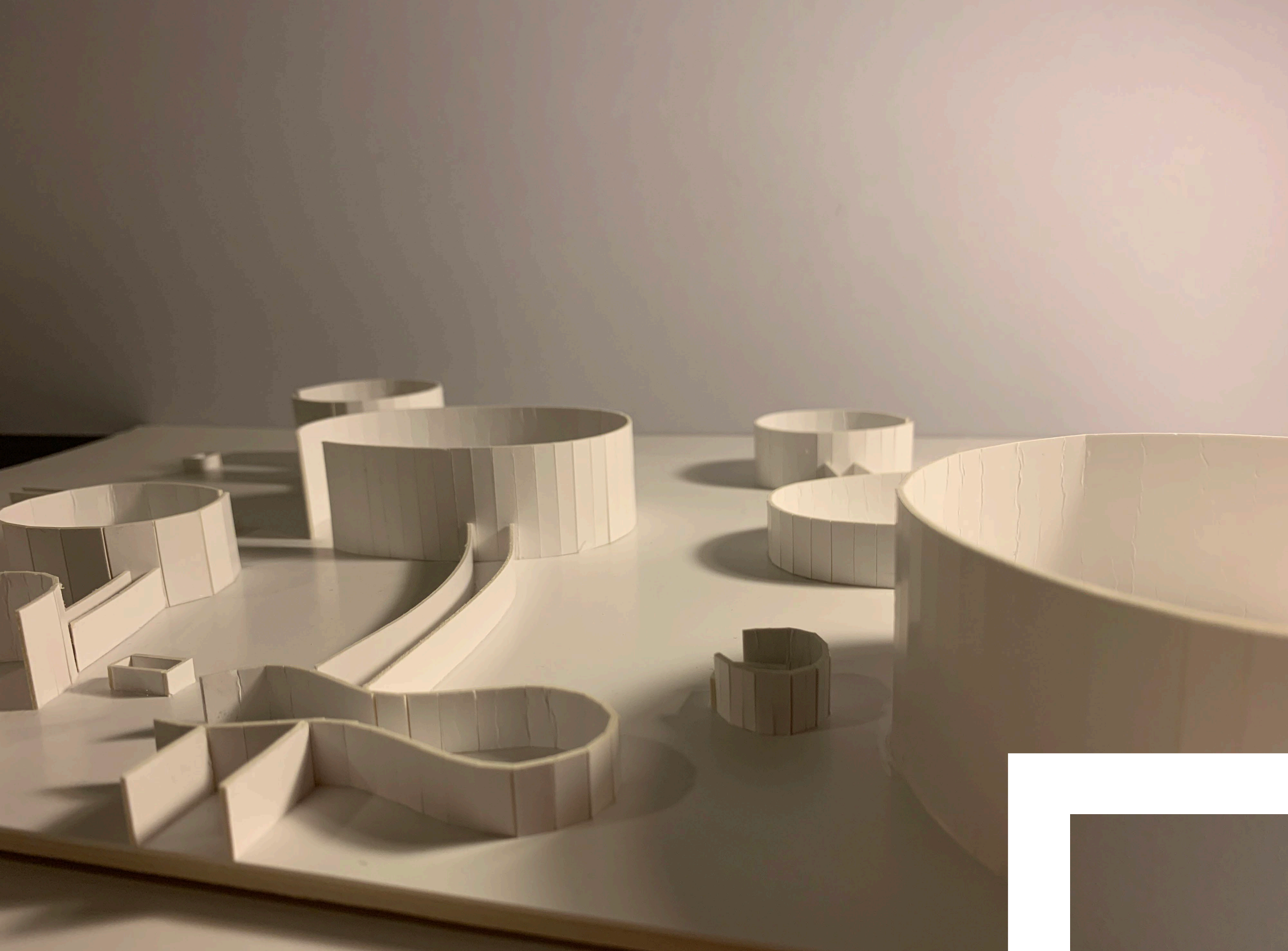

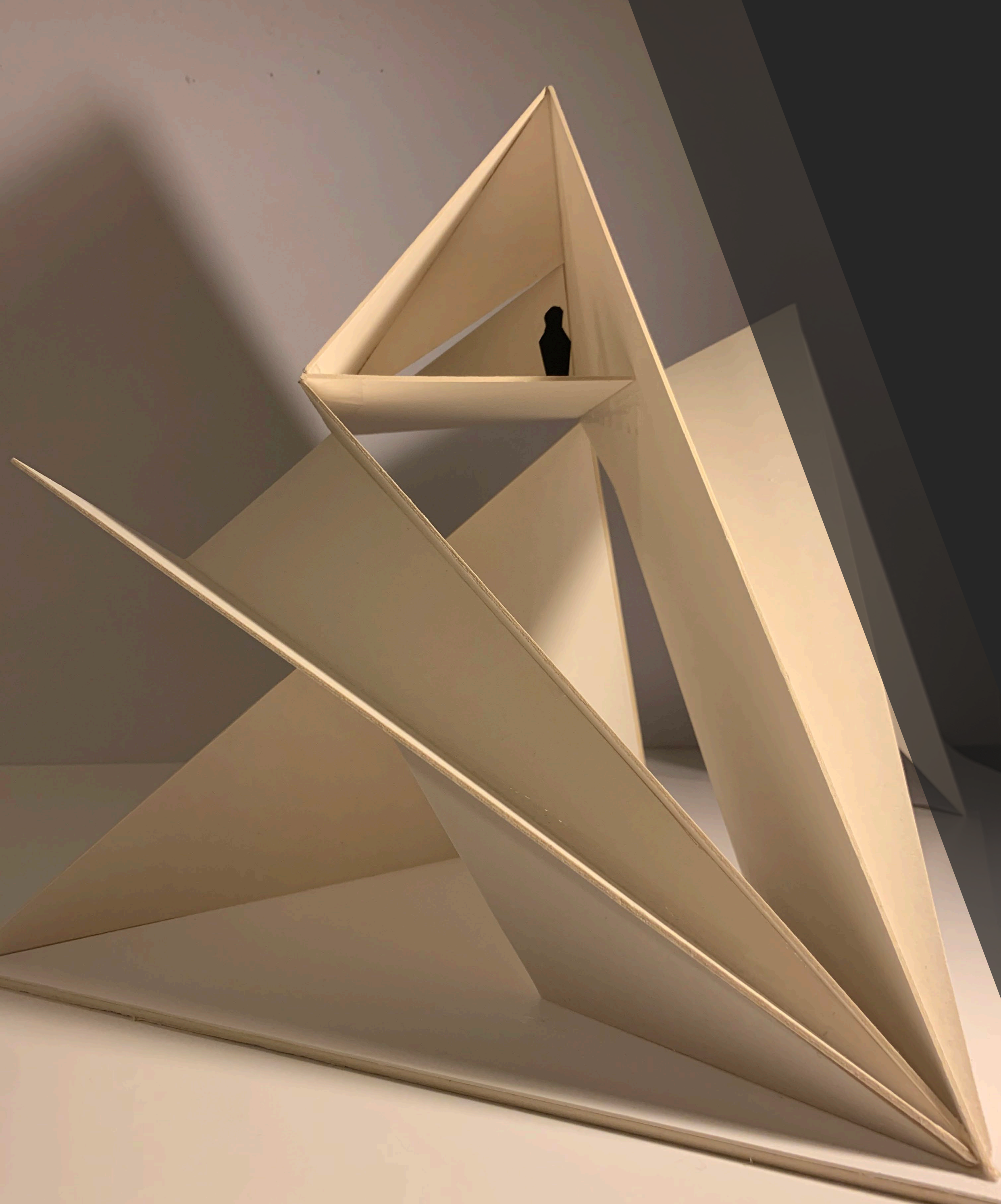

MODEL PROSTORU

