

SKICÁŘ

Tomáš Bajer

Ateliér architektonické
kompozice

A+S, ZS 2020/2021

Ateliér Pošmourný, Boříková,
Koubek Michaličková

INSPIRACE



HLEDÁNÍ MOTIVU

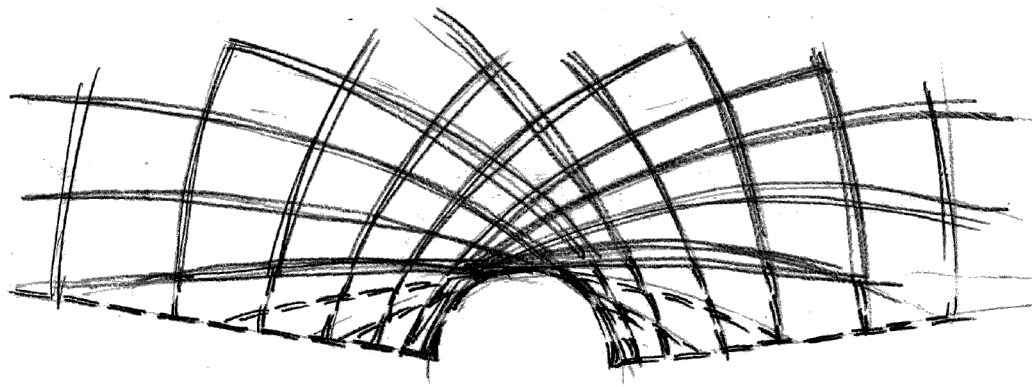
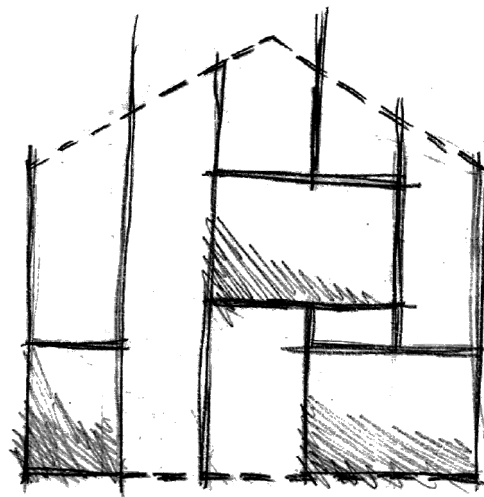
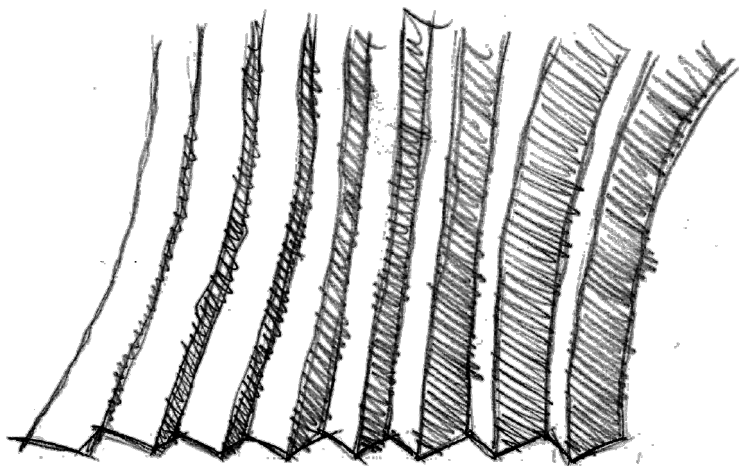

HLEDÁNÍ MOTIVU

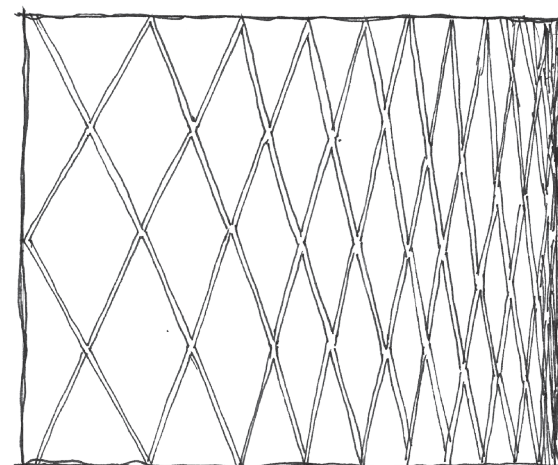
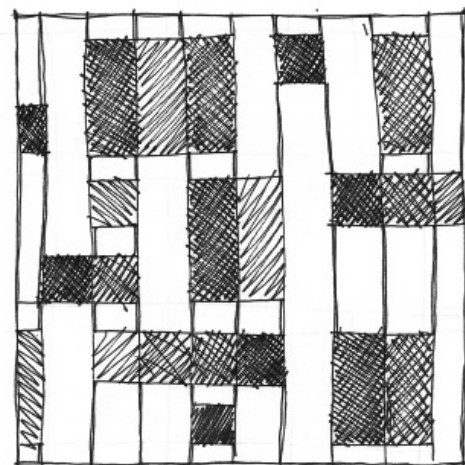
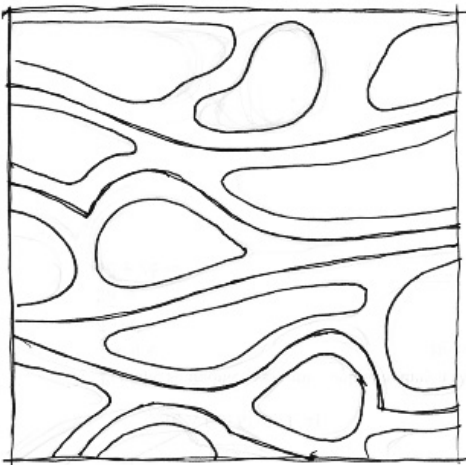
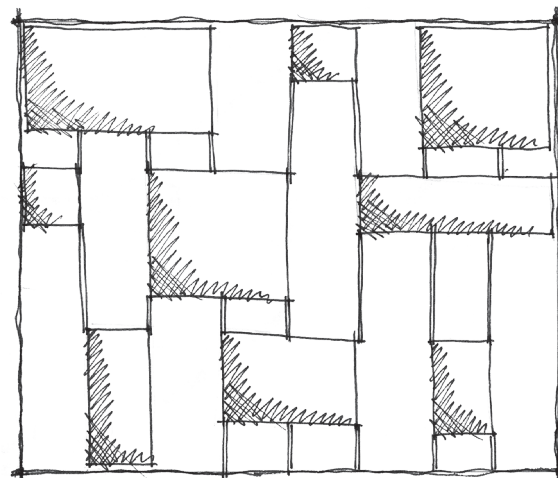
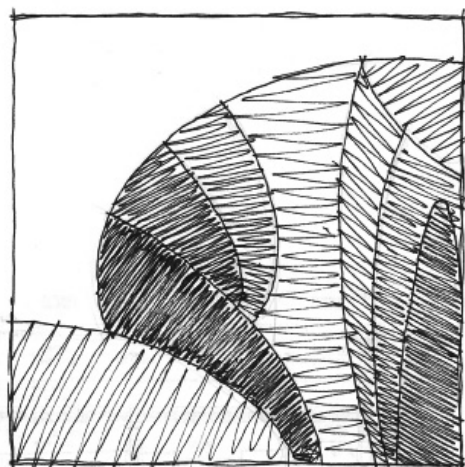
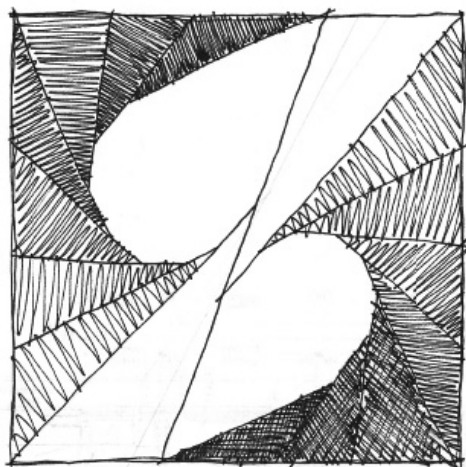

PLOŠNÁ KOMPOZICE

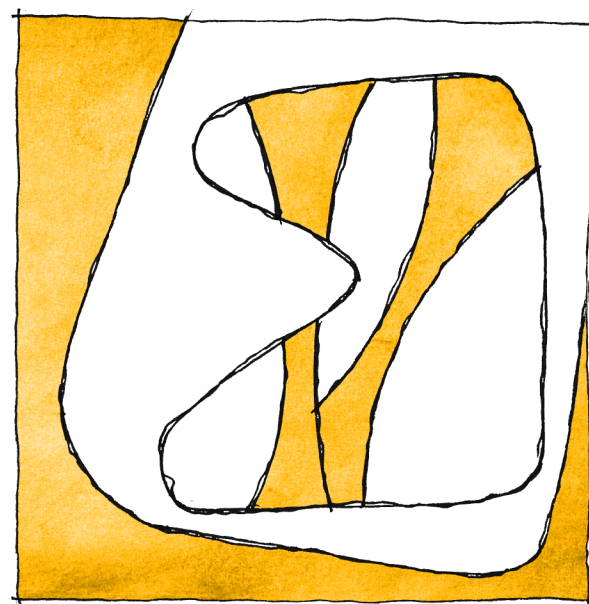
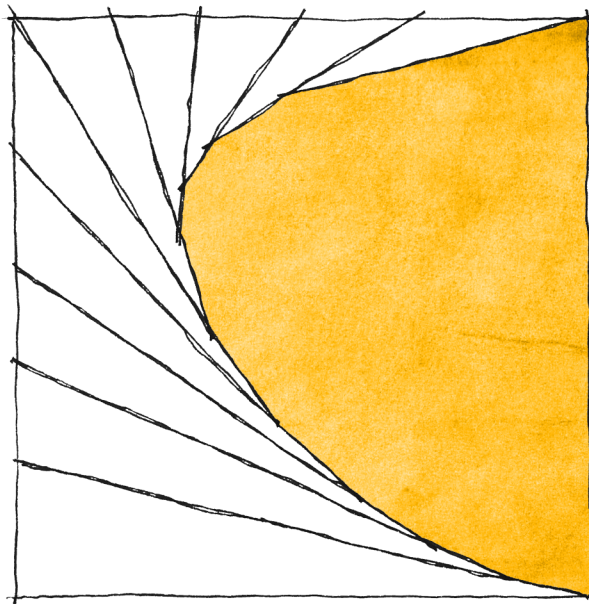
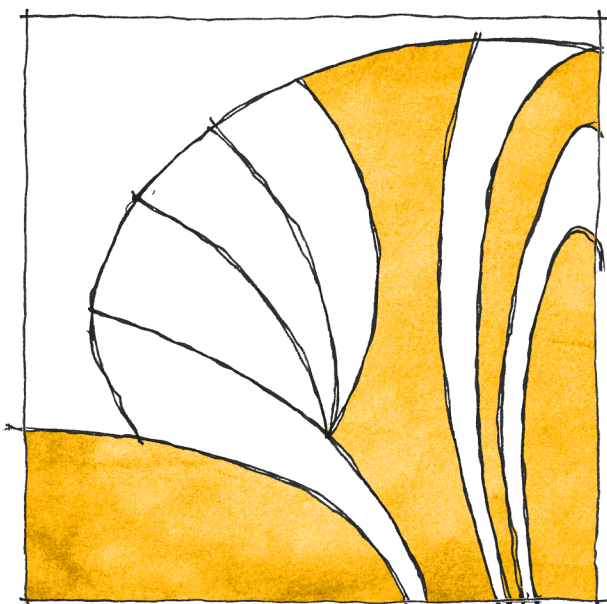

NÍZKÝ RELIÉF

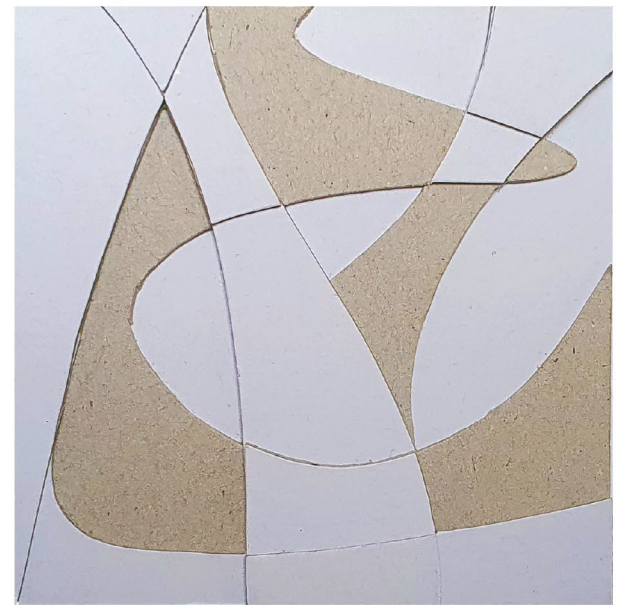

NÍZKÝ RELIÉF

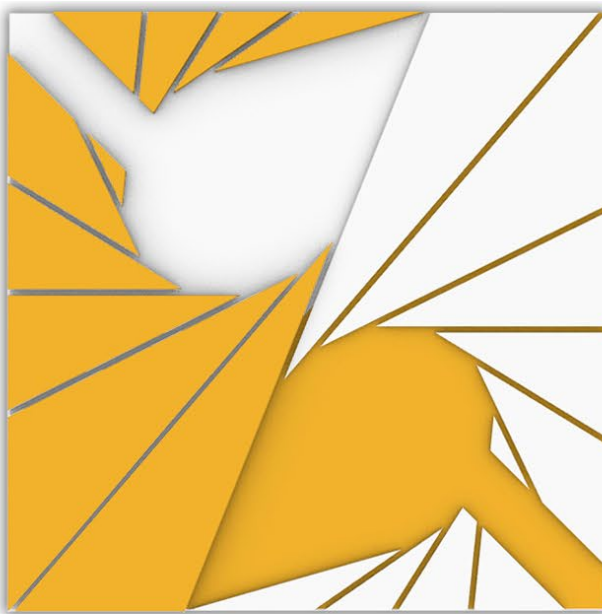

VYSOKÝ RELIÉF

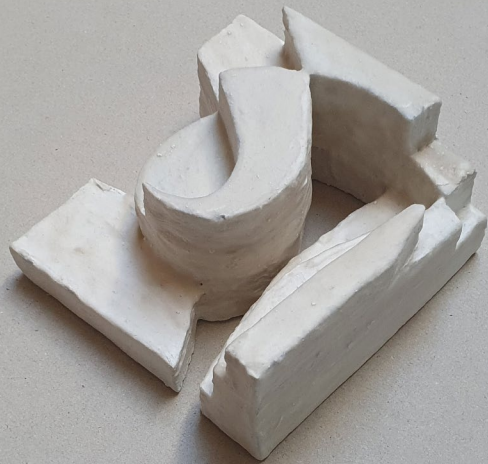

VYSOKÝ RELIÉF



VYSOKÝ RELIÉF



VYSOKÝ RELIÉF

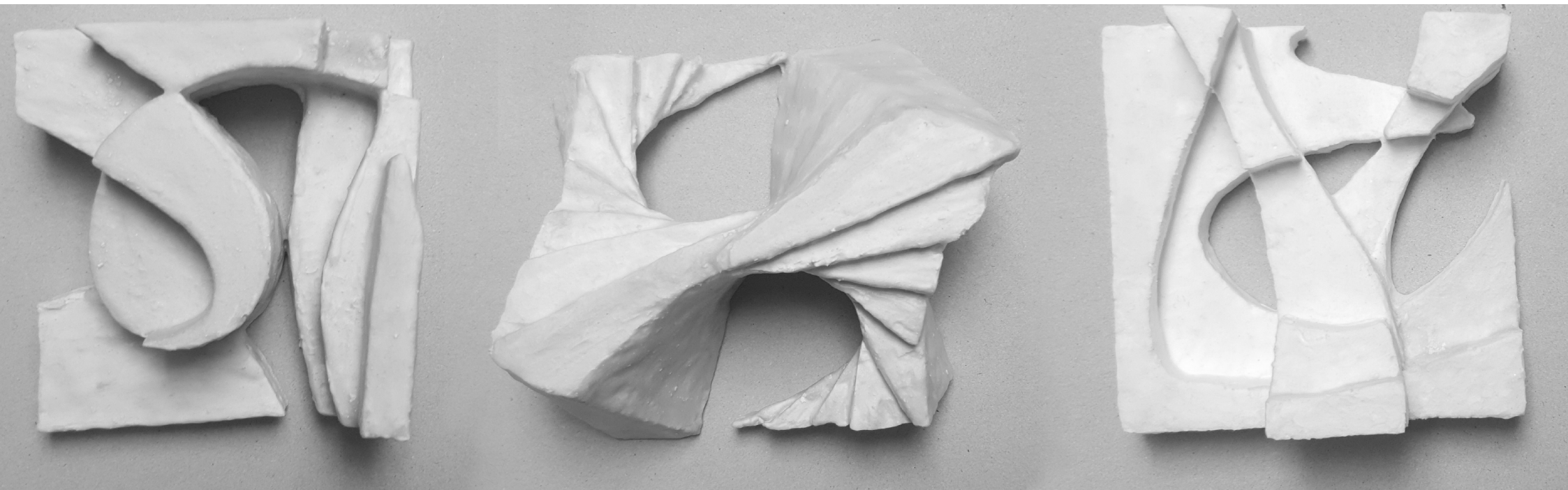

VYSOKÝ RELIÉF

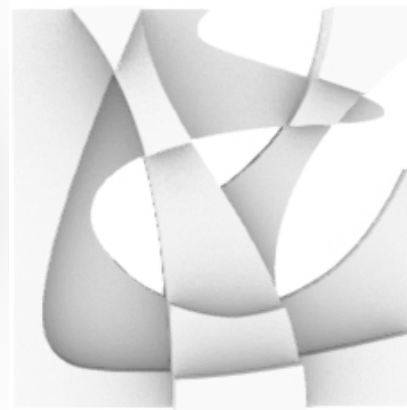
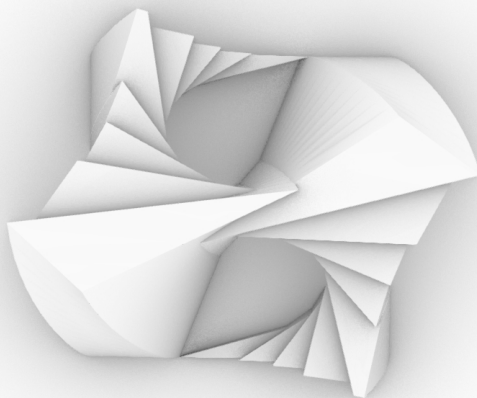

SKICI MODELU

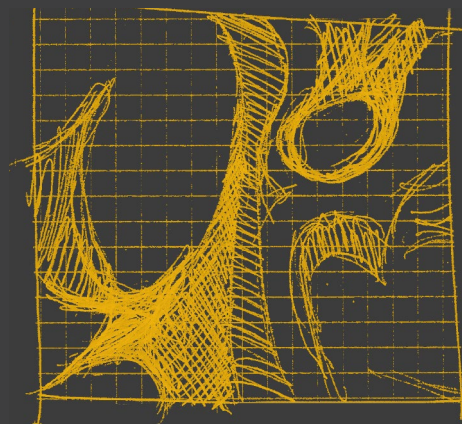
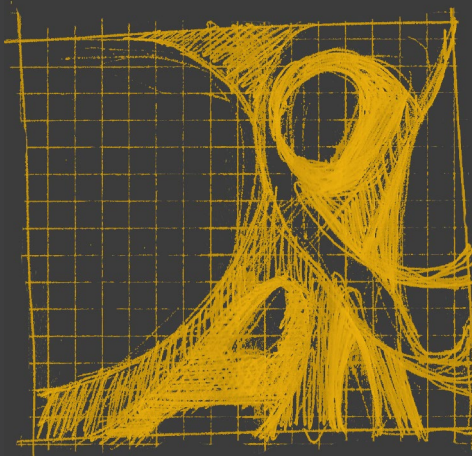
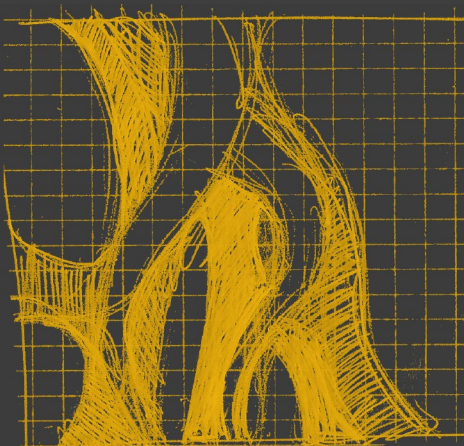
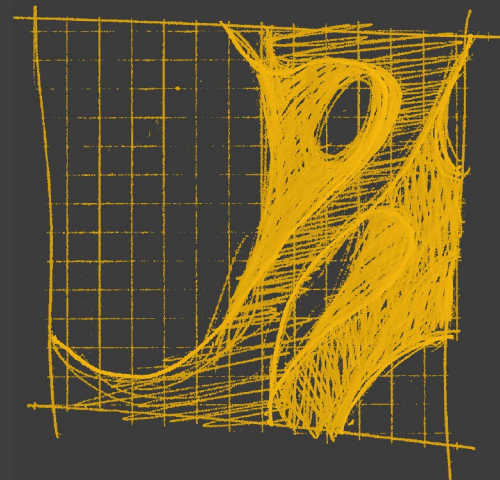
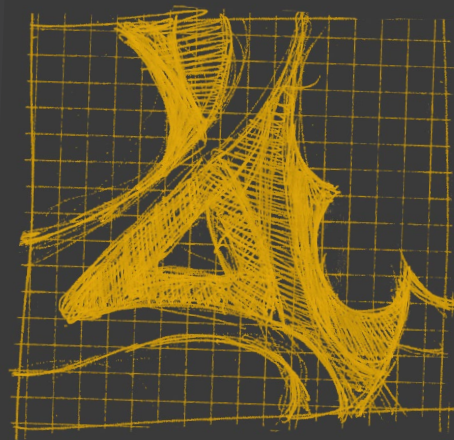
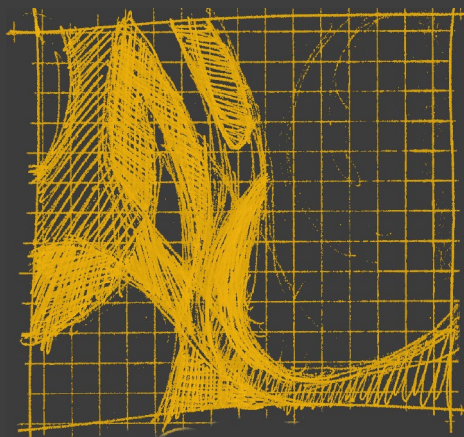

POČÍTAČOVÝ MODEL

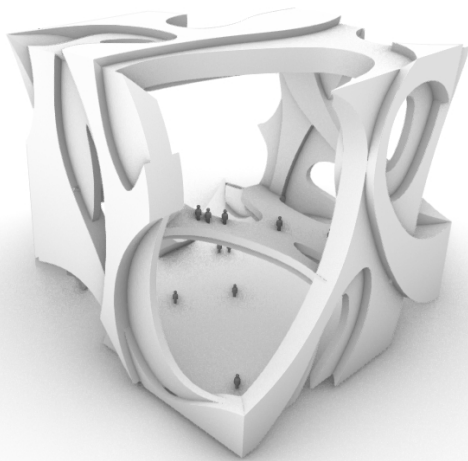
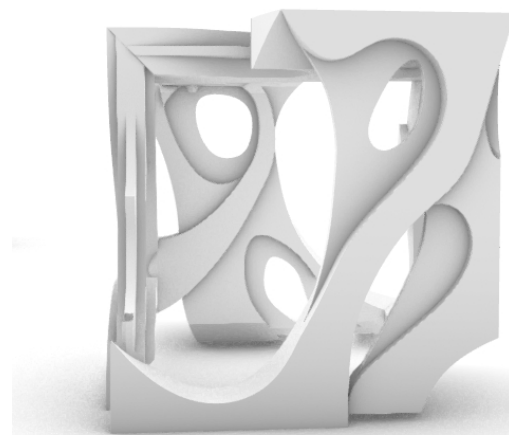

FYZICKÝ MODEL





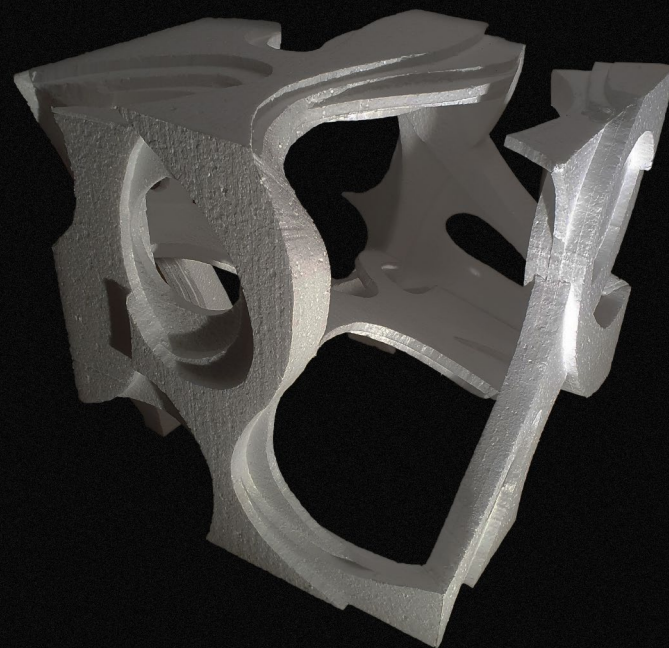

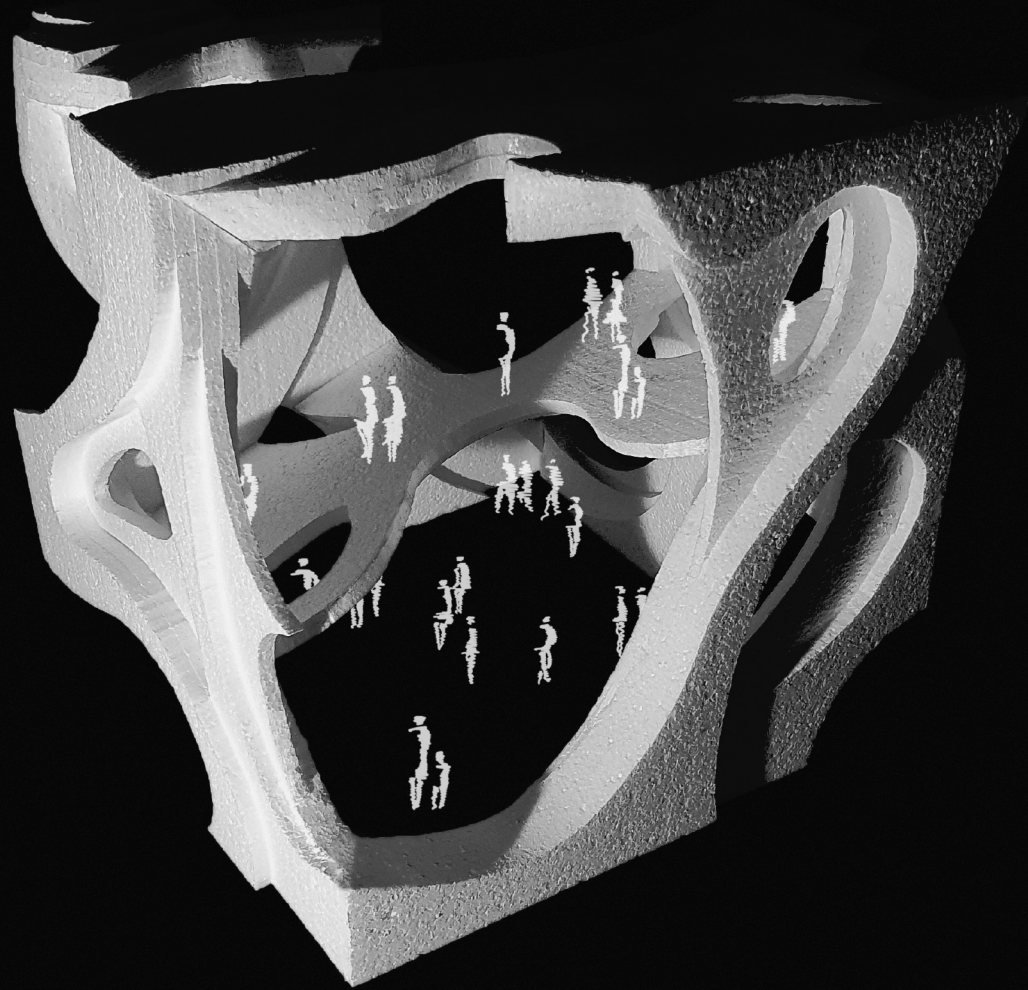

DĚKUJI ZA POZORNOST

Tomáš Bajer

Ateliér architektonické
kompozice

A+S, ZS 2020/2021

Ateliér Pošmourný, Boříková,
Koubek Michaličková