



THE GOAL OF THE PROJECT IS TO DESIGN A SCHOOL FOR A PLACE IN CAMBODIA WHICH WE COULD CHOOSE FREELY.
THIS IS A BRIEF INTRODUCTION TO THE LOCATION CHOICE PROCESS FOLLOWED BY THE PROPOSED DESIGN.

THE PROJECT IS LOCATED IN THE KINGDOM OF CAMBODIA, SOUTHEAST ASIA

97.1% Buddhism
2.0% Islam
0.9% Christianity

CAMBODIA IS HOME TO 17 MILLION PEOPLE OF MOSTLY KHMER ETHNIC GROUP AND LANGUAGE

WITH THE FAMOUS ANGKOR WAT BUDDHIST TEMPLE FROM 12TH CENTURY

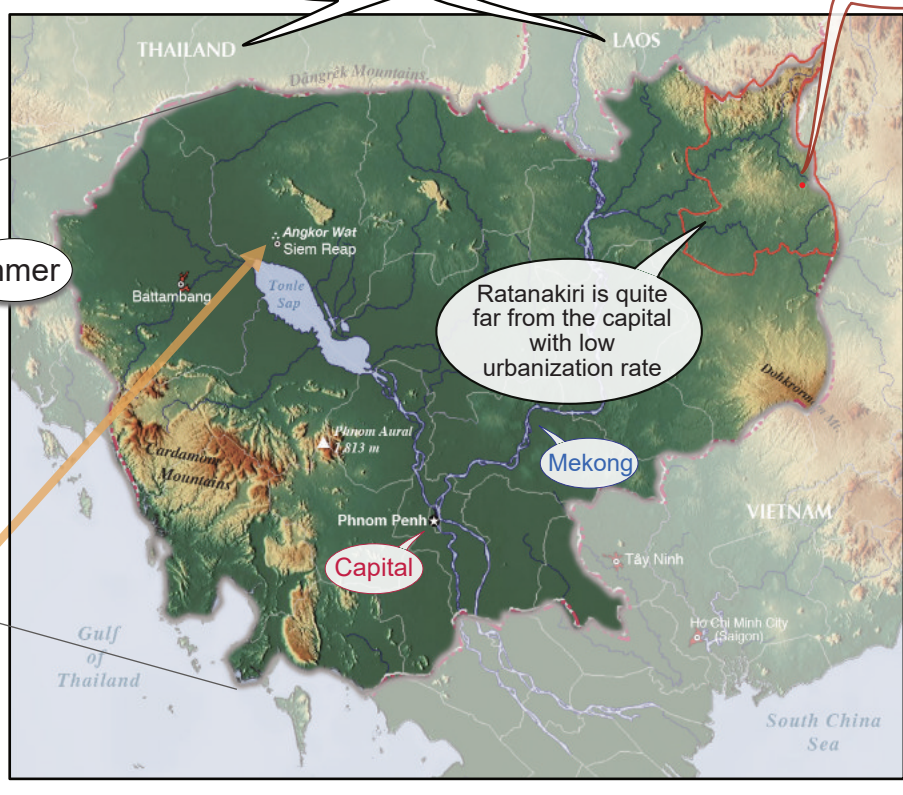

FOR THE PROJECT WE CHOSE REGION RATANAKIRI BECAUSE OF ITS POVERTY AND LOW LITERACY RATE.

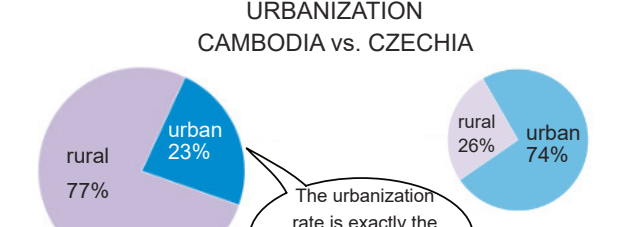
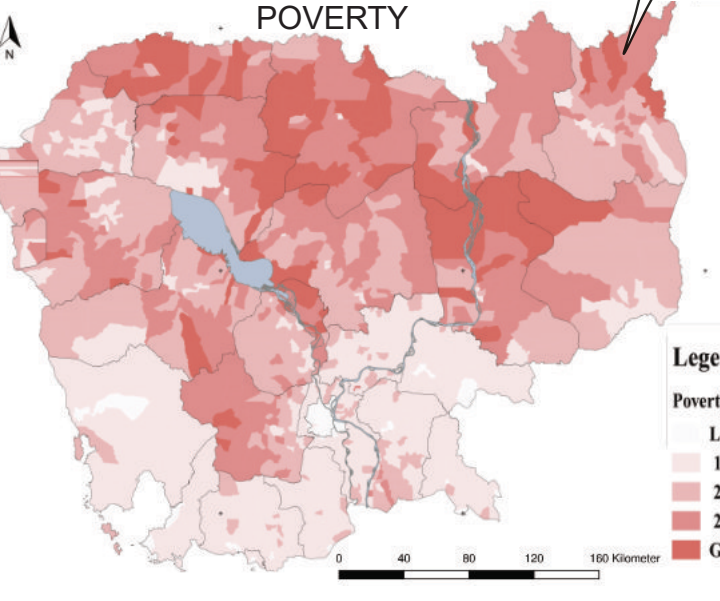

IN CAMBODIA MOST OF THE PEOPLE LIVE ON THE COUNTRYSIDE AND WORK IN AGRICULTURE SINCE POLYOT ELIMINATED MOST OF THE INTELLECTUALS IN THE COUNTRY.

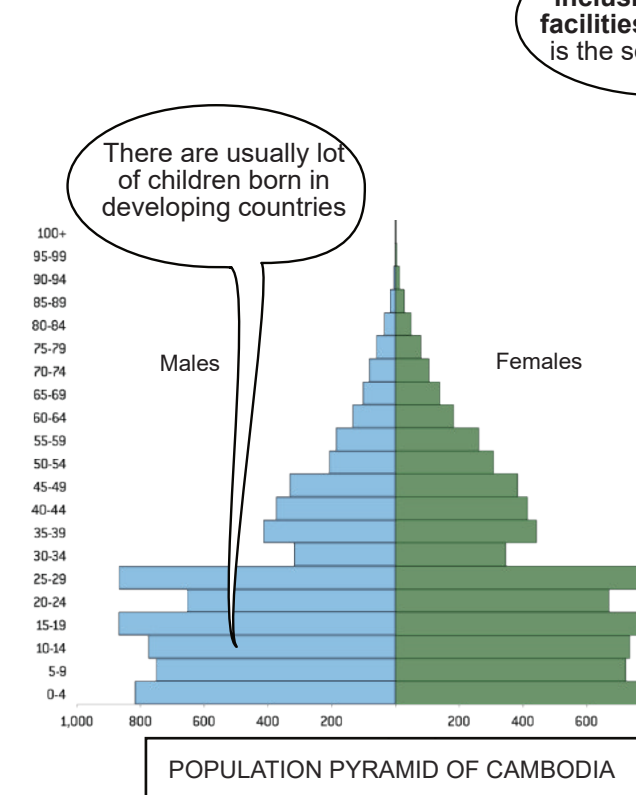

CALL WITH AN ENGINEER EXPERIENCED IN DESIGNING PROJECTS IN CAMBODIA

COLLECTION OF INFORMATION AND NEEDS OF THE LOCALS

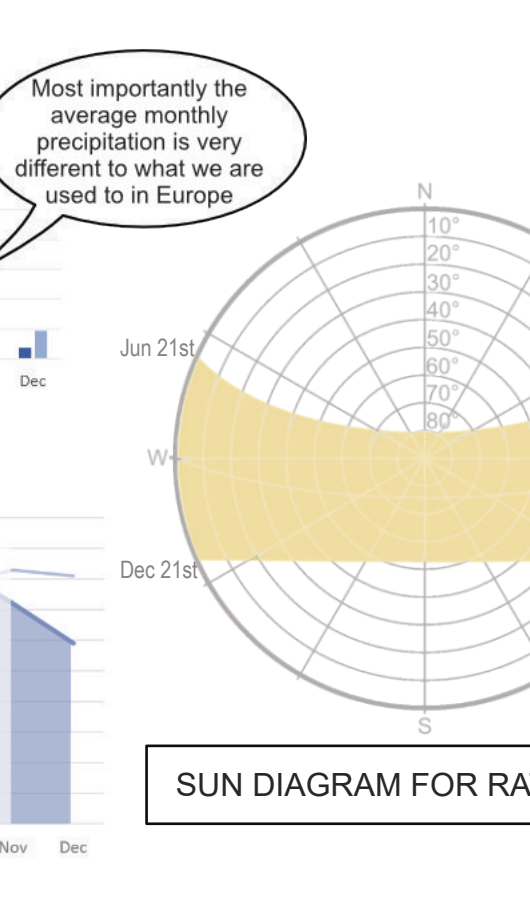
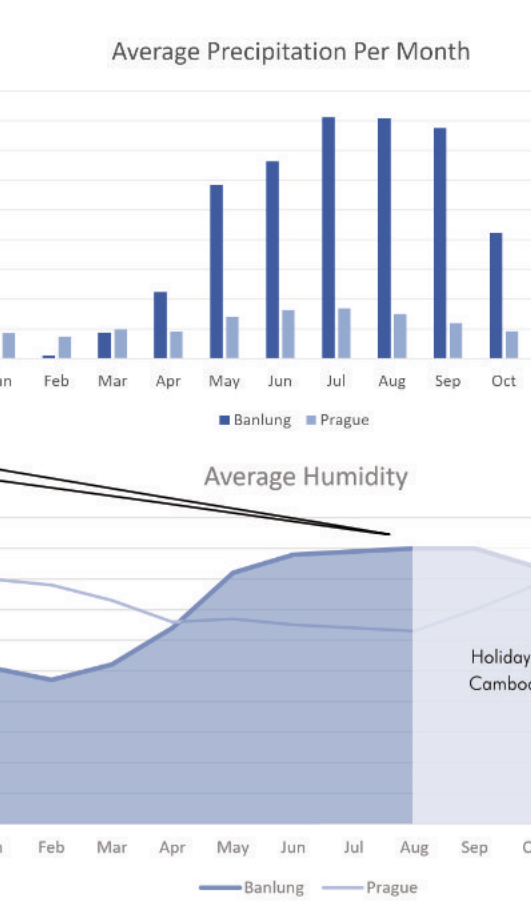
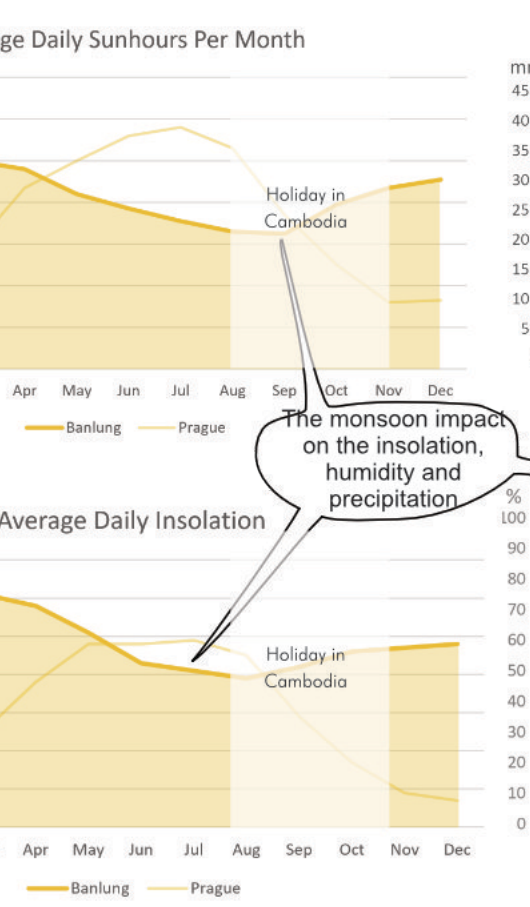
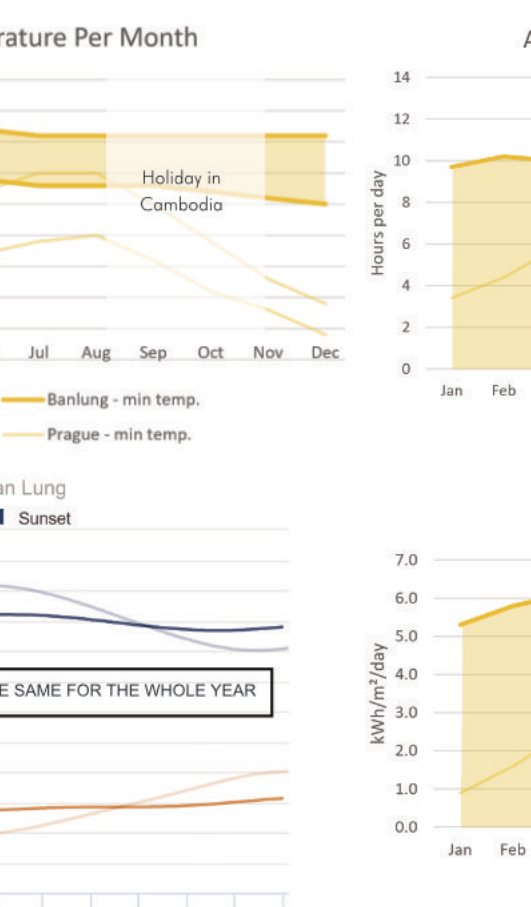
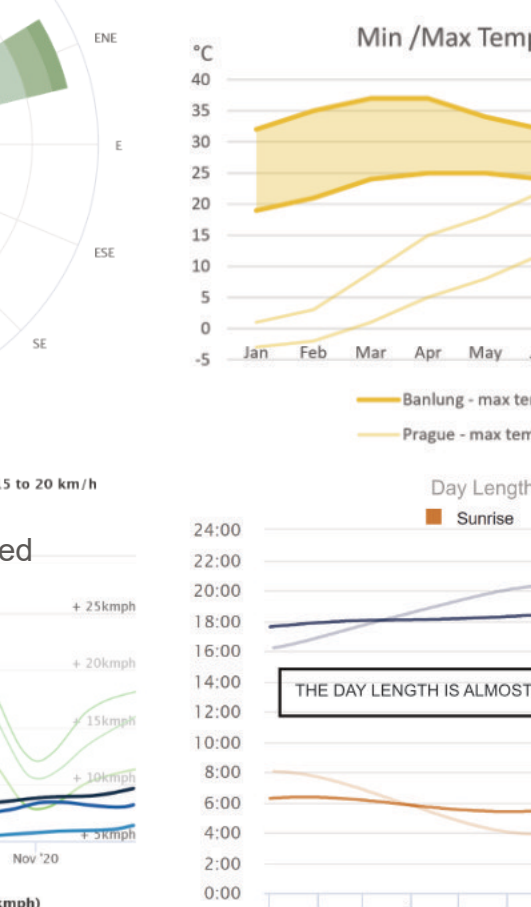
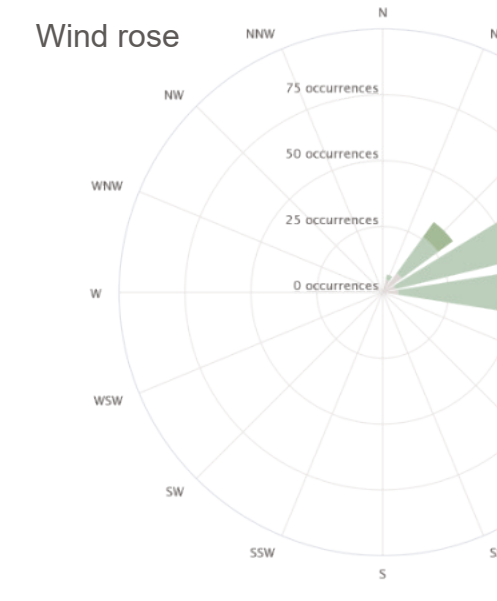
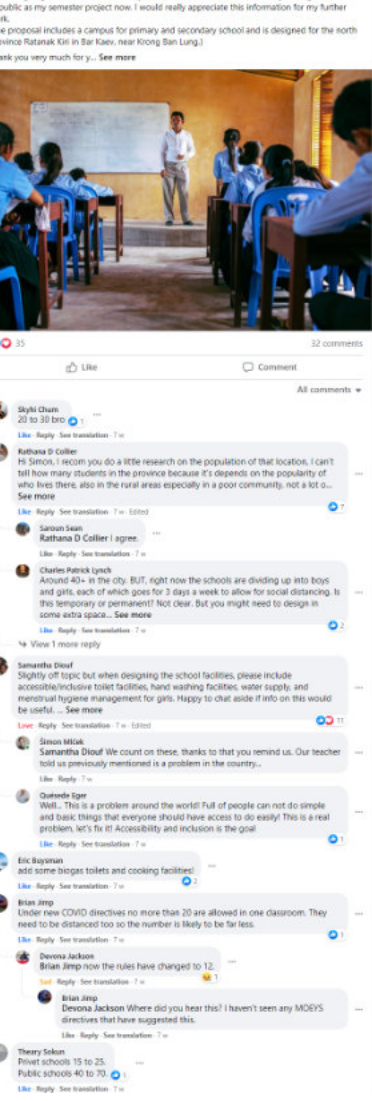

CONCEPT
Modular and adjustable for different villages
Light construction
Local materials
Comfortable interior temperatures, natural ventilation and light
Durability and easily fixable
Monsoon friendly

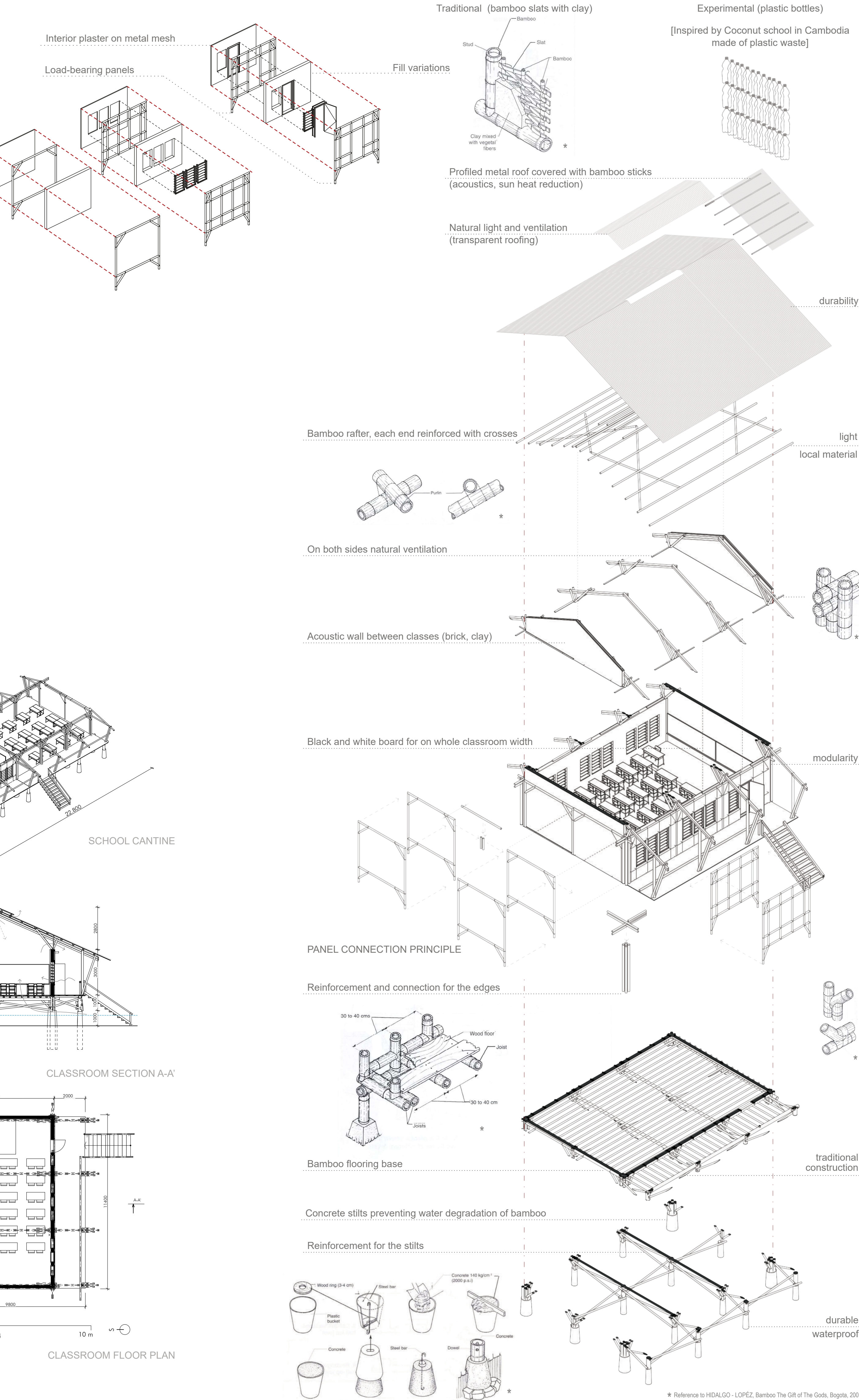
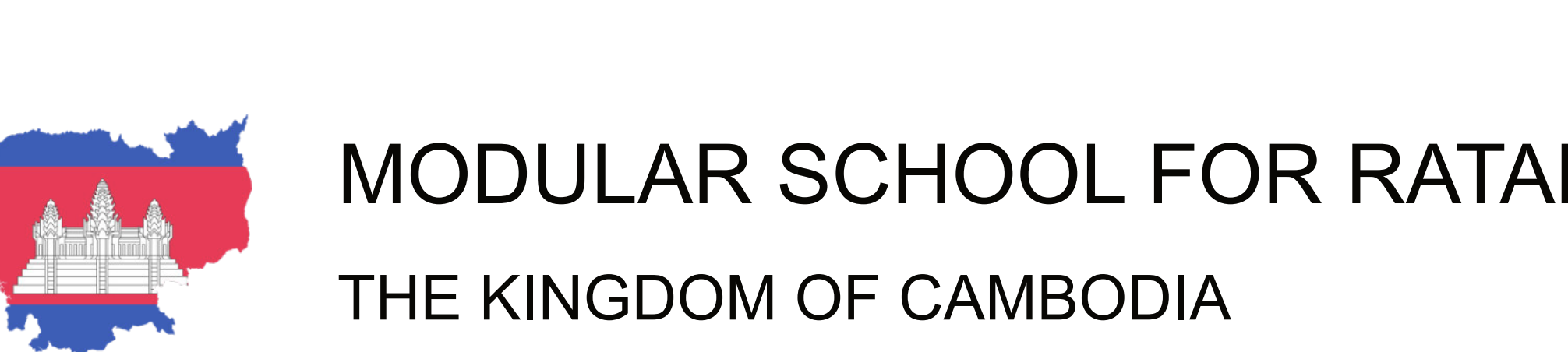
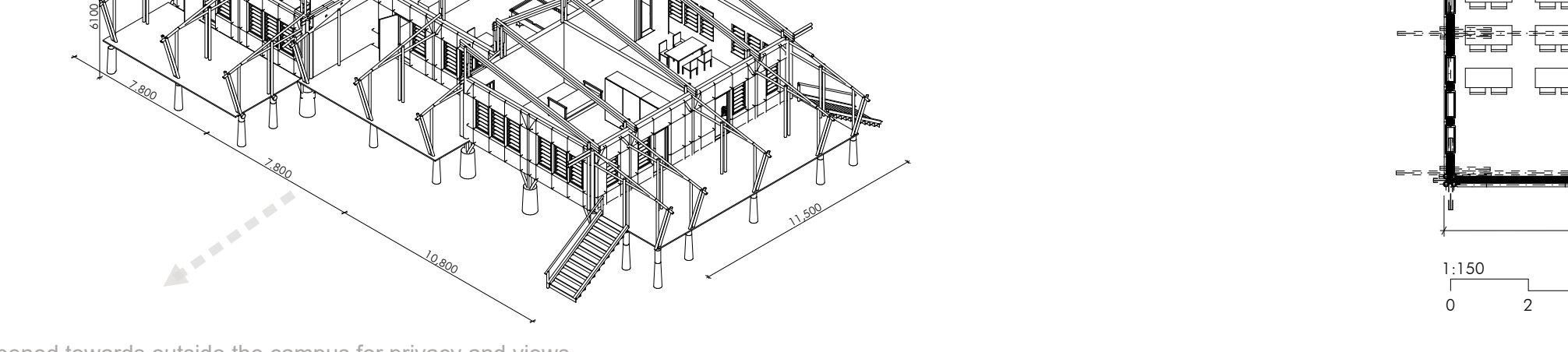
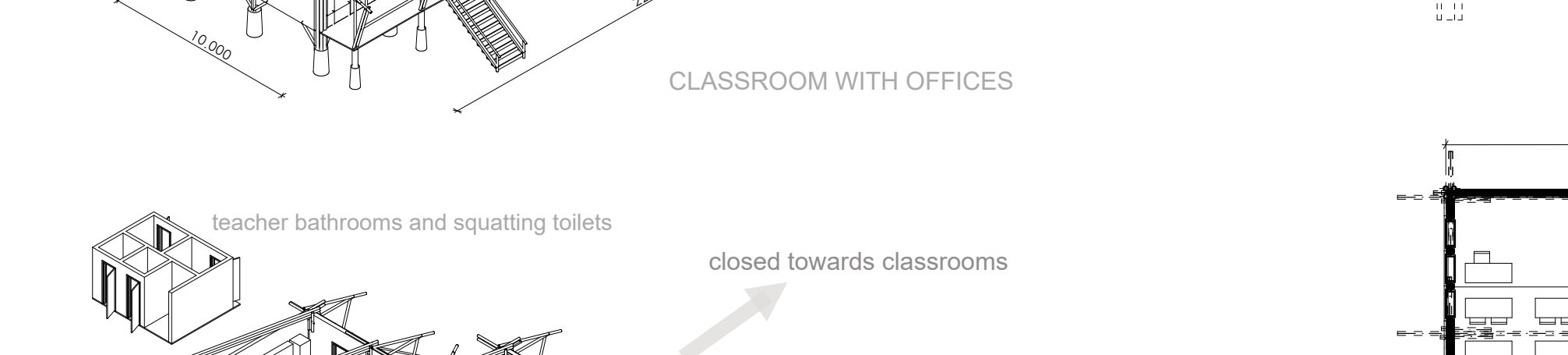
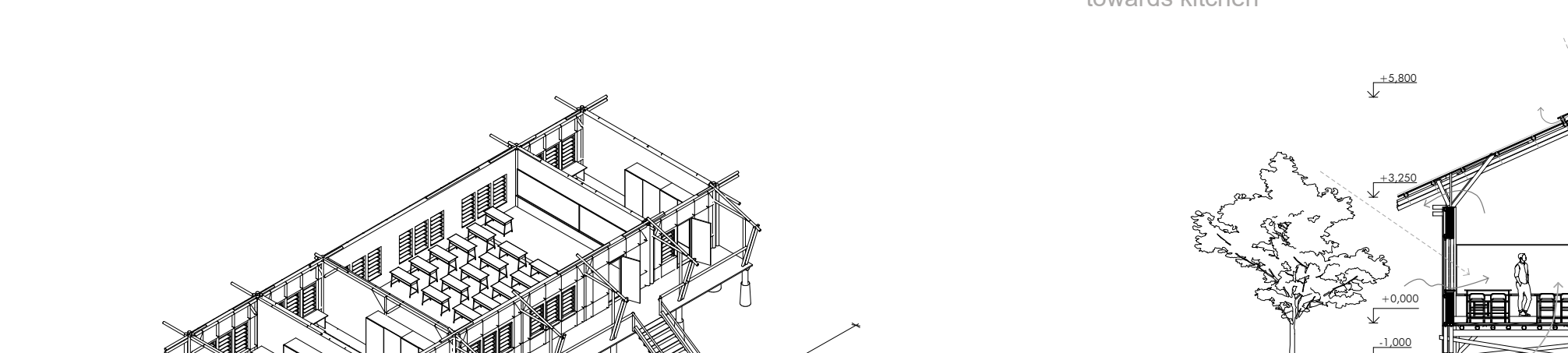
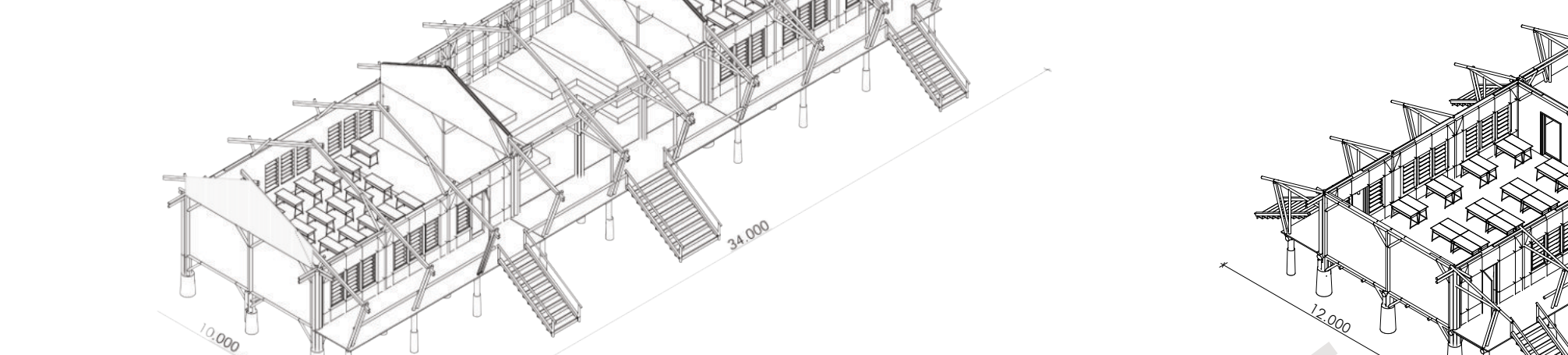
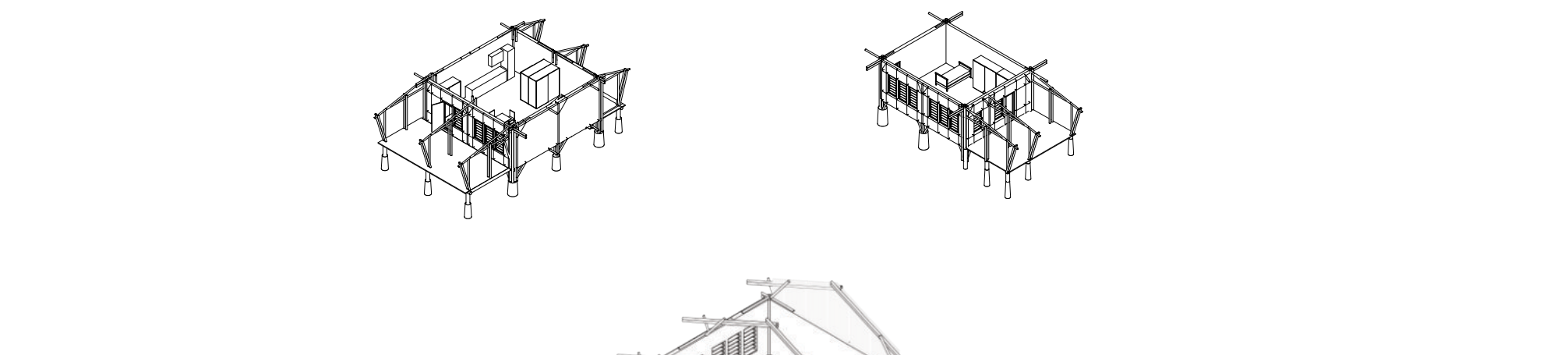
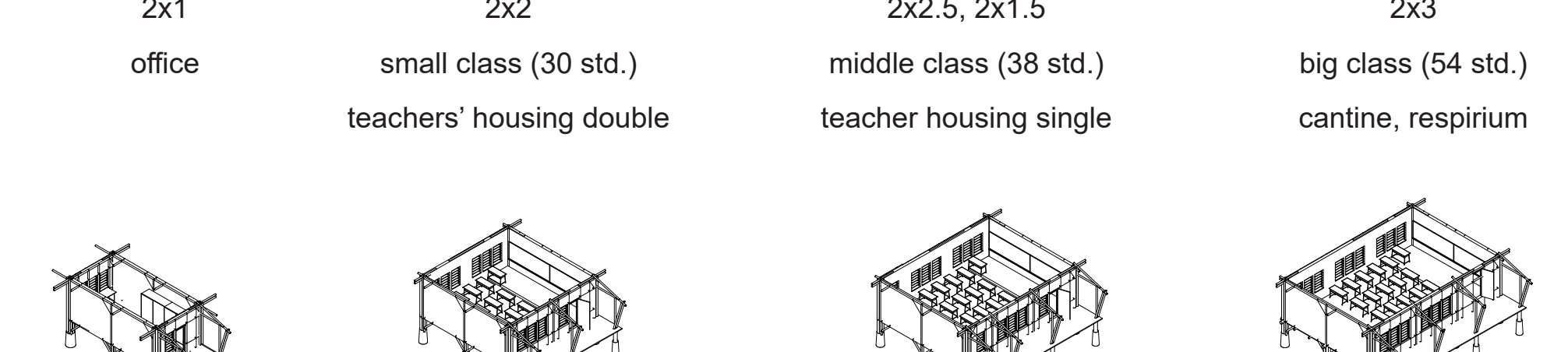
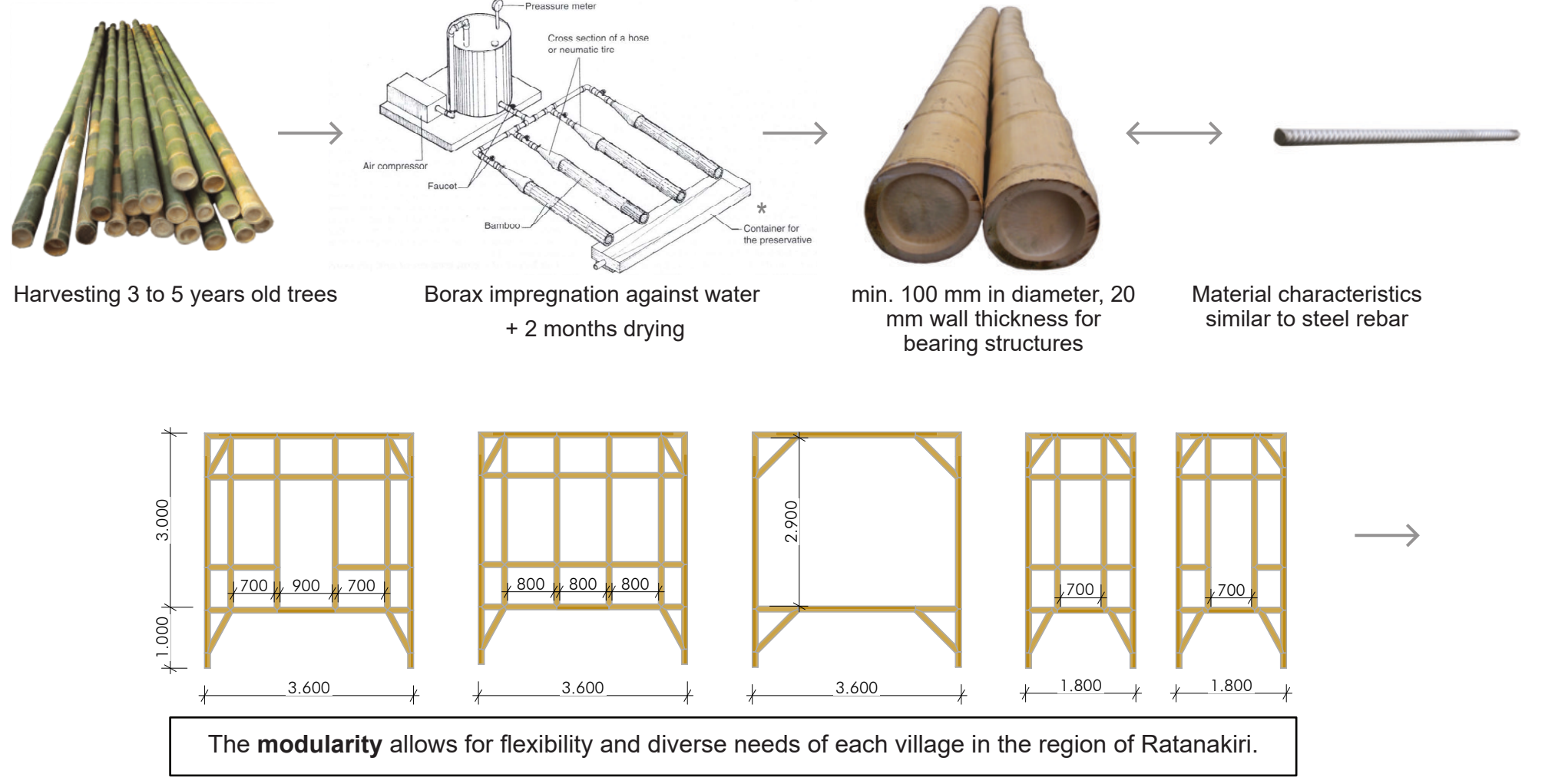

MODULAR SCHOOL FOR RATANAKIRI
THE KINGDOM OF CAMBODIA

ŠIMON MLČEK
ATELIER TILINGER
A + S FSU CTU
AT02 WS 21/22

